

Roger™ Pass-around

Hurtig guide



roger



PHONAK
life is on

Produktbeskrivelse

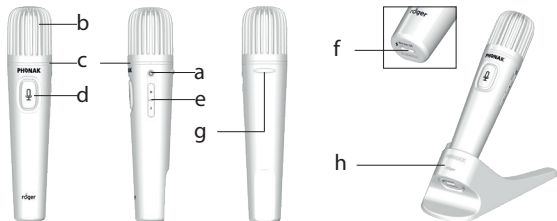

a Av/på

e Lydnivå +/-

b Mikrofon

f micro-USB

c Indikatorlys

g Motvirker rulling

d Mute eller PTT

h Bordstativ

Komponenter



Roger Pass-around



Pose



Bordstativ

Forpakningen kan varierer avhengig av land.

1

Lader

A

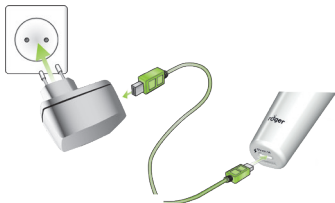

B

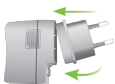

C

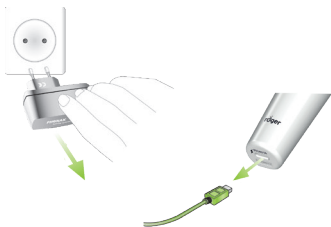

Slå av/på



Koble til

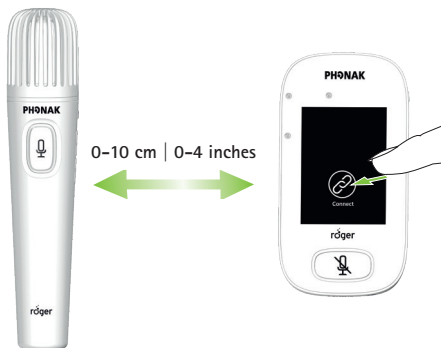

Koble Roger Pass-around til Roger Touchscreen Mic før første gangs bruk [Connect].

Hvordan bruke?

A

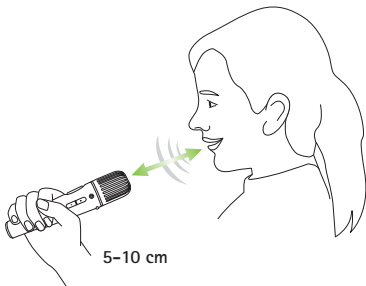

B

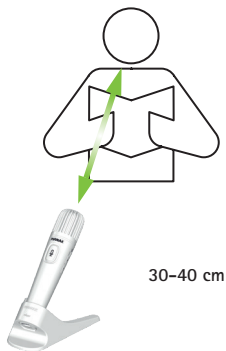

Aktiver og bruk PTT



Push-To-Talk (PTT)	
Activated	✓
Deactivated	

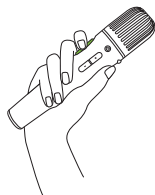
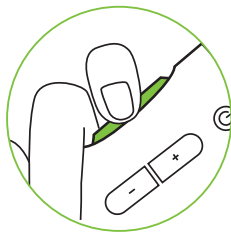

5–10 cm

Høytlesing (PTT)

A

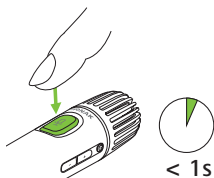

B

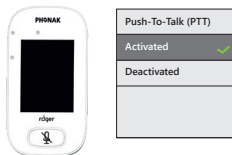

C

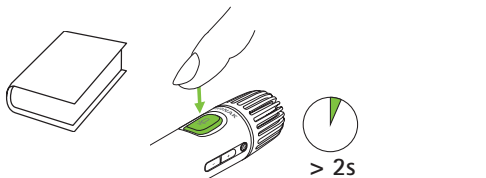



Phonak Communications AG
Laenggasse 17
CH-3280 Murten
Switzerland

www.phonak.com/phonak-roger



Mute (manuelt)

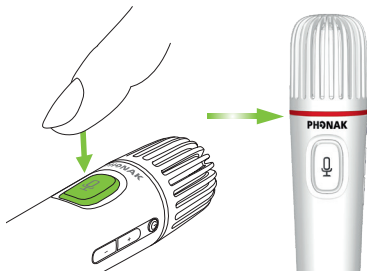

Automatisk mute

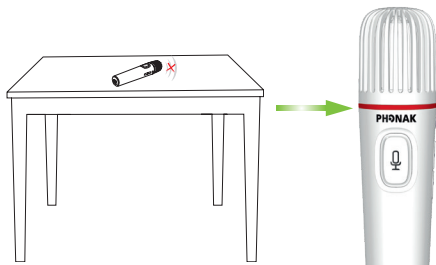

Mikrofonvolume og Digimaster høytaler



Tryk for å justere mikrofonvolume på høytaler midlertidig



Indikatorlys



Av/På



Lader



Fullt oppladet



Stemmeoverføring



Mute





Mikrofon standby (PTT mode)



Primær-mikrofon ikke tilgjengelig

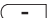

  Volume



Indikatorlys



Av/På



Lader



Fullt oppladet



Slått på



Lad opp enheten



Operation range
Betriebsreichweite
Plage de fonctionnement
Alcance en funcionamiento

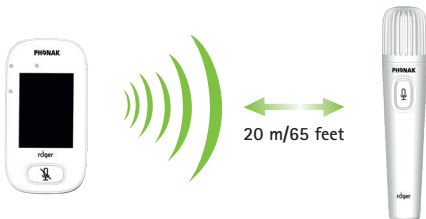

Out of range! If distance greater than 20 meters/65 feet
Ausser Reichweite! Wenn der Abstand größer als 20 Meter ist
Hors de portée! Si distance supérieure à 20 mètres
¡Fuera de alcance! Si la distancia es mayor que 20 metros

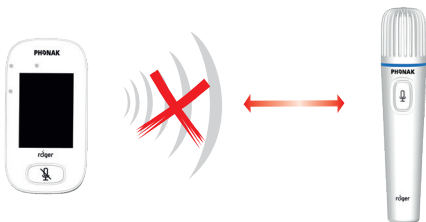



Reset
Zurücksetzen
Réinitialiser
Reiniciar





Only Roger transmitters running on software version 4.x are compatible with Roger Pass-around.

Nur Roger Sender, die über die Software-Version 4.x verfügen, sind mit dem Roger Pass-around kompatibel.

Seuls les émetteurs Roger ayant la version 4.x ou plus élevée sont compatibles avec Roger Pass-around.

Sólo emisores Roger que utilizan la versión de software 4.x y la siguiente son compatibles con Roger Pass-around.

Operating conditions:

Betriebsbedingungen:

0° to + 45° Celsius

Conditions de fonctionnement:

32° to +113° Fahrenheit

Condiciones de funcionamiento:

<95%

Relative humidity | relative Luftfeuchtigkeit | humidité relative | humedad relativa



>8



Waste Electrical and Electronic Equipment Directive

Elektro- und Elektronikgeräte-Abfall Richtlinie

Directive déchets d'équipements électriques et électroniques

Instrucciones de Residuos de Aparatos Eléctricos y Electrónicos



CE marking

CE-Kennzeichnung

Marquage CE

Marca CE



Class II



Indoor use



Important to read

Wichtig zu lesen

Important de lire

Importante de leer



ACMA - AUS/NZ

