

# HJELPEMIDDEL™ PARTNER

## HURTIGGUIDE

Vi håper du blir fornøyd med din nye Active Power Assist Glove. De fleste trenger litt trening for å mestre denne, slik som med mange andre hjelpemidler. Det er en egen teknikk å lære seg, spesielt med å få aktiveringsknapp til å treffe underlaget. Vi anbefaler at man sitter inntil et bord med hardt underlag når hansken skal benyttes. Det er også verdt å merke seg at hansken kan kobles fra controller om man ikke ønsker å ha denne tilkoblet når man holder noe (f.eks en skje).

For de som ønsker å ha på seg hansken over tid, så kan controller festes i buksen. Ledninger kan da enkelt bli skjult under jakke eller genser, slik at bare de ledningene som kommer ut av ermet synes.

### 1. Koble til plug fra controller til hanske

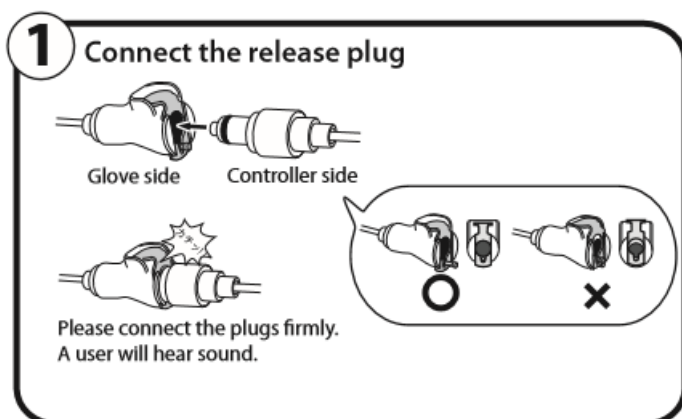

### 2. Installere CO2 tank (dette kan ha blitt gjort allerede av leverandør)

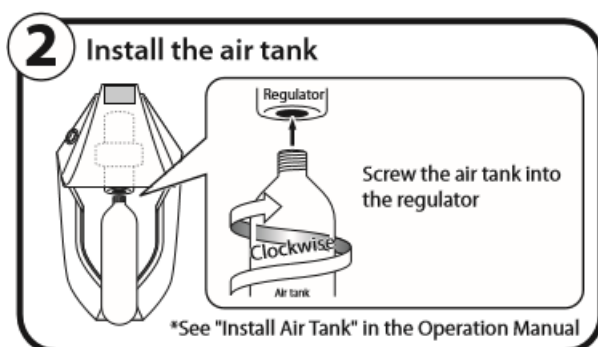

3. Ta på hansken. Husk å ta ned glidelås.

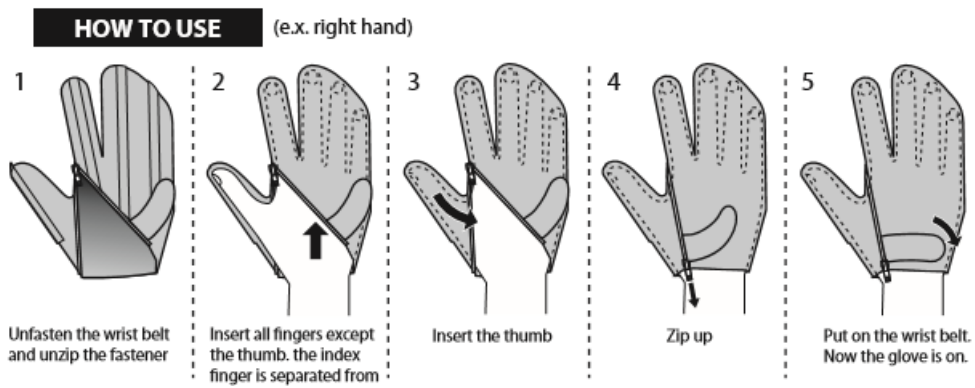

4. Skru på controller (øverst på controller)

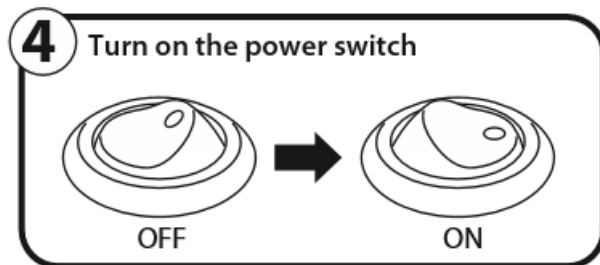

5. Aktiver hansken med den lille knappen (festet på hansken)

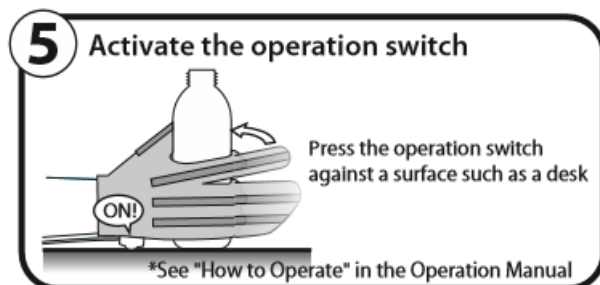

## 6. Hvordan gripe om en gjenstand?

- Den lille knappen aktivere og slipper gripefunksjon. Det er viktig at den får et raskt og lett trykk (ellers vil den ikke fungere riktig).
- Knappen kan plasseres over store deler av hansken som er kledd med borrelåsm det samme er knappen (se nederste bildet)

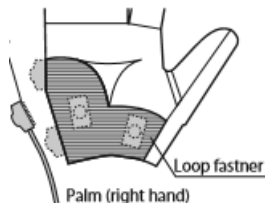
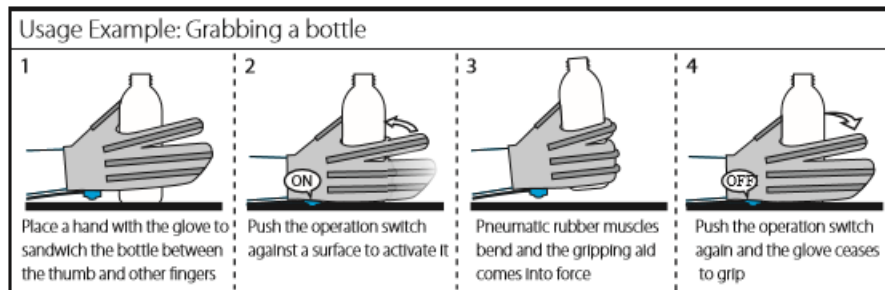

Velcro:

## Hansken virker ikke?

1. CO2 patron er oppbrukt
2. Batteri i controller må skiftes

## Rengjøring

1. Hansken kan vaskes i vaskepose på 30 grader i maskin på et skånsomt program
2. Husk at hanske kan slites ut, og må byttet etter en tid.

## Sikkerhet

1. Ikke åpne Co2 patron før den er helt tom. Dette kan medføre skade.
2. Unngå kontakt med gassen når den åpnes. Kald co2 kan skade huden.
3. Unngå overdreven bruk av PAG i små uventilerte rom.
4. Om du hører unormale lyder som lekkasje må du kontakte Hjelpemiddelpartner AS umiddelbart.

5. Hold utstyret unna barn.
6. Ikke overopphet eller kjøøl ned patron. Hold unna sigaretter og åpen ild.

### **Uskifting av patron**

1. Må gjøres av en person med full førlighet i hender
2. Skru patronen sakte av.
3. 3. Litt co2 vil komme ut ved bytte av patron. Skru nu patron godt til før bruk

### **Fare ved bruk**

1. Innhalering av store mengder Co2 kan være skadelig
2. Kontakt med gass kan føre til frostskaader.

Ta gjerne kontakt med oss om dere skulle trenge ytterligere informasjon!

### **Leverandør Norge:**

Hjelpemiddelpartner AS

Nordstrandsvegen 13 ( 3.etg)

6823 Sandane

Tlf.- 95079618

Email: [post@hjelpemiddelpartner.no](mailto:post@hjelpemiddelpartner.no)

# PA Power Assist Glove

**Power Assist Glove** supports grip power and extends a user's fingers by air pressure. It assists activities of daily living and rehabilitation. It is subjected to elders with weakened hands and people who are disabled on their fingers by brain injuries.

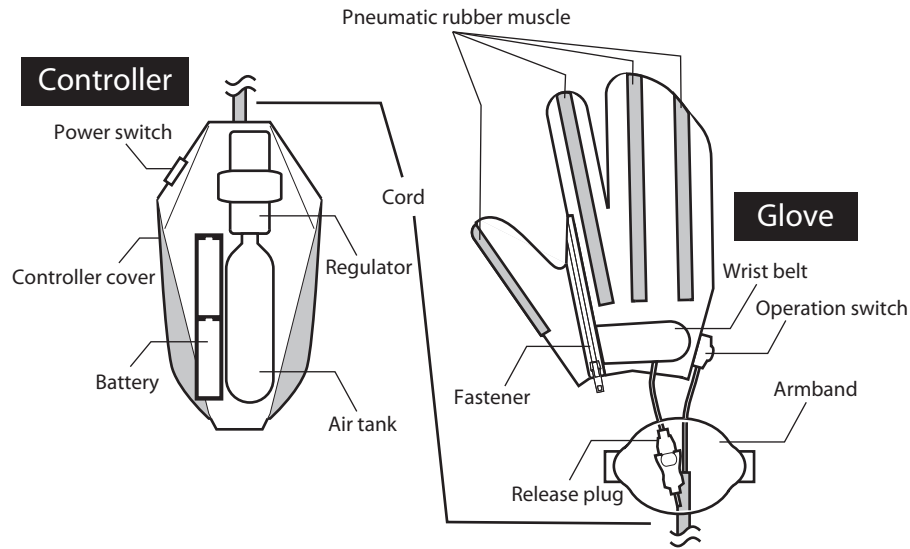

Power switch	Main switch to turn the glove on/off
Air tank	Pressure source to move the pneumatic rubber muscles; filled with CO2
Regulator	Adjusts pressure inside the air tank to the proper level for the pneumatic rubber muscles
Battery	Power source for the electronics; two batteries needed
Controller cover	Stabilizes parts in the controller; protects the user from the chill of the regulator and air tank
Code	Bundles the piping and wiring that connect the glove and controller
Pneumatic rubber muscles	Light, pliable actuators that flex when pressure is supplied; they bend along with fingers and aid grip
Operation switch	Controls the gripping force; turns on/off when pushed; detachable and can be placed conveniently for users
Release plug	Has a valve to set/release pressure-supplying piping that connects the glove and controller
Fastener	Placed on the back of the hand; unzips wide to make it easy to put on the glove
Wrist belt	Tightens to secure the glove at the wrist; put on the belt last and fasten firmly
Armband	Settles the cord onto the arm; cover protects the release plug

## Size Guide

In Centimeter (CM)	S	M	L
Wrist Circumference	14 - 16 cm	16 - 18 cm	18 - 20 cm
Hand Circumference	17 - 19 cm	19 - 21 cm	21 - 23 cm
Length of middle finger	6.5 - 7.5 cm	7.5 - 8.5 cm	8.5 - 9.5 cm

This package contains one glove and one controller and three pages instruction manual.

## INSTALL Air tank

**\*Please make sure that a non-disabled person installs air tank**

1. Turn off both the power switch and operation switch.
2. Unzip the fastener on the controller cover. Insert the screw part of the air tank into the screw hole of the regulator.
3. Screw in the air tank clockwise while keeping it vertical. It becomes more difficult to screw at about half way, but be sure to insert the screw completely.
4. Put the air tank in the controller cover and zip it up.
  - \*When screwing in the air tank, the gas may leak a little, but screw it in fully.
  - \*Use only the air tank specified by our company.
  - \*Install by hand. Do not use any tools.
  - \*Make sure that escaping gas does not come in contact with your face or hands.
  - \*If the gas decreases rapidly after installing the air tank, some parts may not be installed properly

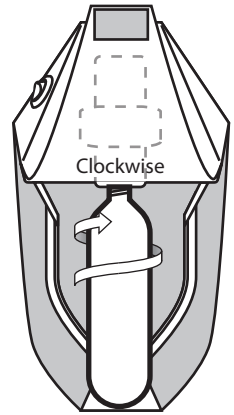

## REPLACE Air tank

**\*Please make sure that a non-disabled person replace air tank**  
**\*The air tank should be empty.**

The air tank should be empty, when the glove does not work even with the power and operation switches on. Otherwise the issue is due to a lack of battery power or a breakdown.

1. Turn off both the power switch and operation switch.
2. Unzip the fastener below the regulator, and expose the air tank from the controller cover.
3. Slowly unscrew counterclockwise. Pause when you hear gas escaping.
4. When the remaining gas stops leaking, continue unscrewing counterclockwise and remove the air tank.
5. Install a new air tank, following the instructions under "Install Air Tank."
  - \*Confirm there is a hole at the tip of the used air tank, and dispose of it according to each municipality's rules

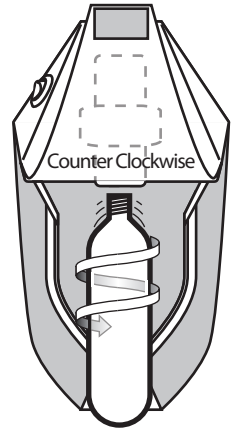

## HOW TO USE

(e.x. right hand)

1. Unfasten the wrist belt and unzip the fastener
2. Insert all fingers except the thumb. the index finger is separated from the three other fingers
3. Insert the thumb
4. Zip up
5. Put on the wrist belt. Now the glove is on.



## Attach operation Switch

The operation switch is detachable with Velcro. Attach it to the desired spot within the piled area on the palm side.  
Do not attach it on other than piled area as it can result in scratches and damage.

## How to operate the glove

1. Make sure the release plug is set and power switch is off.
2. Put on the glove and turn on the switch.
3. Attach the operation switch to the glove
4. Turn on the operation switch by pushing it. Then pneumatic rubber muscles bend and the gripping aid comes into force.
5. After use, turn off the operation switch as well as the power switch.

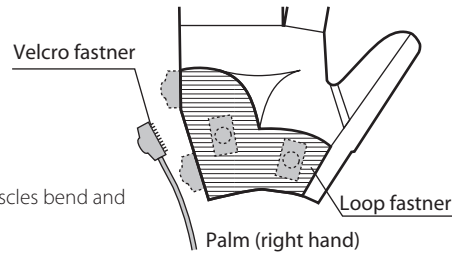

## Handling Instruction

### For Glove and Controller

1. Be sure to confirm the apparatus is free of defects before using.
2. Use the apparatus in safe environment. Do not handle in dangerous manner.
3. Stop using immediately if a defect, such as a gas leak, is found.
4. Do not handle the apparatus with wet hands.
5. Do not apply excessive force. It could break inner parts and cause a malfunction/breakdown.
6. When not using the glove for a long period of time, make sure the power switch is turned off or remove the batteries from the controller and store the apparatus.

### For Glove

1. The pneumatic rubber muscles may blow out at some point. If this happens, you may hear a bang. If the pneumatic rubber muscles blow out, immediately turn off the power switch and operation switch, stop using the glove and contact Daiya Industry.co.Ltd..
2. Do not touch or grab objects with a sharp edge.
3. Please note that the pneumatic rubber muscles can deteriorate if not used for a long period of time.
4. Please do not use the glove beyond its gripping aid capacity such as grabbing something too heavy.
5. Resisting the gripping aid may blow out the pneumatic rubber muscles or deteriorate their durability.
6. A user should gradually increase the amount of time wearing the glove.

### For Controller

1. Make sure there is no residual pressure when detaching and replacing the air tank.
2. Keep the air tank vertical when installing it. The screw should be on top.
3. Place the air tank in the controller cover and zip it up when using the glove.
4. Do not install the air tank while the operation switch and power switch are on. The gas could spray out.
5. If you are unable to turn off the operation switch, turn off the power switch immediately.
6. The regulator could freeze if the glove is used with the controller tilted, causing malfunctions.
7. Use only the dedicated air tank specified by Daiya Industry Co., Ltd..
8. Install the air tank only by hand. Do not use any tools.

## Usage Example: Grabbing a bottle

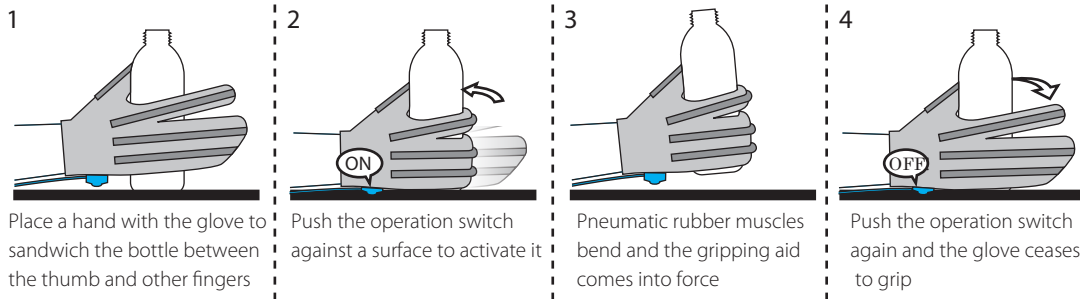

## Washing Instruction

Handwash below 30 degree (ONLY Glove not controller).

1. Turn off both switches
2. Remove release plug and controller, including the operation switch from the glove
3. Seal the release plug with the cap in order to prevent water from getting in.
4. Neutral detergent
5. Air dry in place with good ventilation away from direct sunlight
6. To clean the controller, wet a cloth and wring it out well, then gently wipe away dirt

## Storage Instruction

☀ Do not expose products to direct sunlight, high temperatures or other condition that might cause damage

☔ Store in a dry place with good ventilation

## Disposal Instruction

Proper disposal differs in each country and might even vary within the states, communities etc. of one country. Please confirm with your local guidelines for textile product disposal.

 **Daiya Industry Co., Ltd**

1253 Ofuku, Minami-Ku, Okayama 701-0204 Japan  
TEL: +81-86-282-0377 Email: info@daiyak.co.jp  
www.daiyak.co.jp/English

 **MDSS GmbH**

Schiffgraben 41, 30175 Hannover, Germany

## Precautions

1. CO2 is a colorless, odorless non-flammable gas. It is very dangerous to inhale CO2 in large amounts
2. Do not spray gas onto a person. There is a risk of frostbite if the gas touches the skin or mucous membrane.
3. Never disassemble or reconfigure the regulator. Doing so could result in an explosion.
4. Never heat or cool the regulator and air tank.
5. Do not detach the air tank before it is completely empty. It is very dangerous that remaining gas could spray out rapidly.
6. Never attach an air tank with gas other than CO2.
7. Keep the glove away from children.
8. Do not touch the gas directly, as there is a risk of a low-temperature burn.
9. The CO2 apparatus is a general industry machinery component. It should be handled by those with sufficient expertise.
10. If you find any defect, stop using the glove immediately and contact Daiya Industry Co., Ltd..

## Disclaimer

1. We do not take any responsibility for: accidents or damage caused by users' intentional, accidental or otherwise incorrect usage; and consequences of usage under abnormal conditions.
2. We do not take any responsibility for collateral damage -- such as loss of business interests, business interruption, changes or loss of user' s memory, caused by using our product or disabling it.
3. We do not take any responsibility for damage caused by failure to follow the contents of this manual.
4. We do not take any responsibility for damage caused by glitches due to the combining of devices and software from third parties, or due to efforts to disassemble or reconfigure the product.



# Power Assist Glove Usage Manual

This Usage Manual gives explanations of how to use the glove for easy understanding, supplementing the Operation Manual  
Please read Operation Manual carefully before using and follow its instructions

## Part names

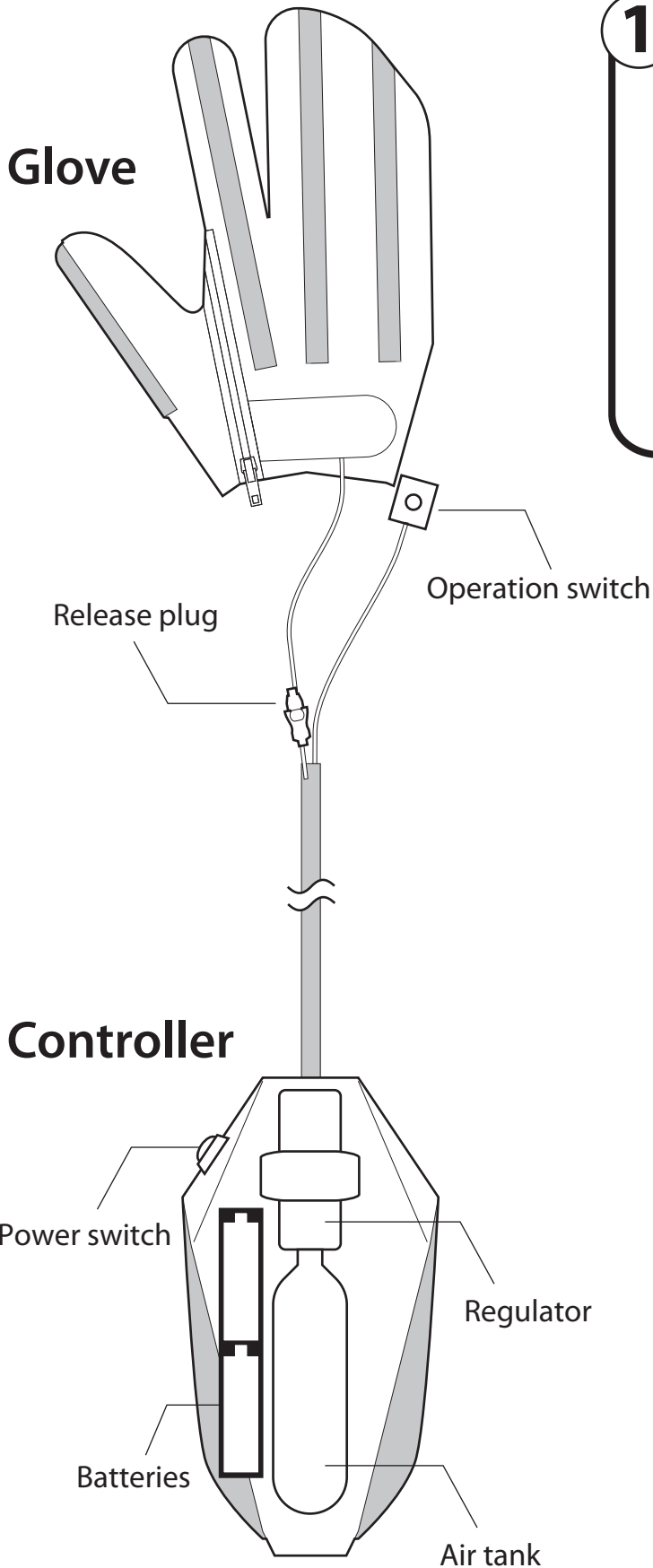

## How to use

### 1 Connect the release plug

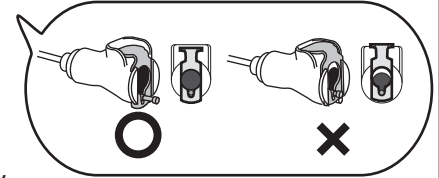
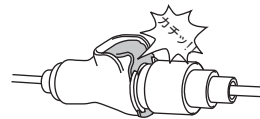
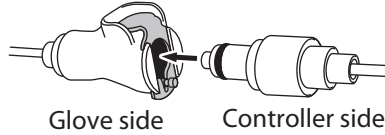

Please connect the plugs firmly.  
A user will hear sound.

### 2 Install the air tank

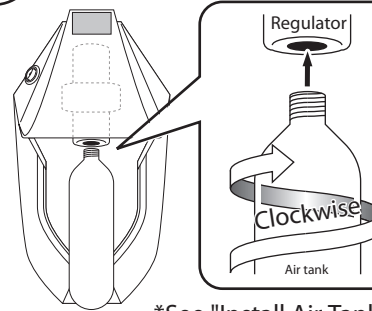

Screw the air tank into the regulator

\*See "Install Air Tank" in the Operation Manual

### 3 Put on the glove

\*See "How to Put on Glove" in the Operation Manual

### 4 Turn on the power switch

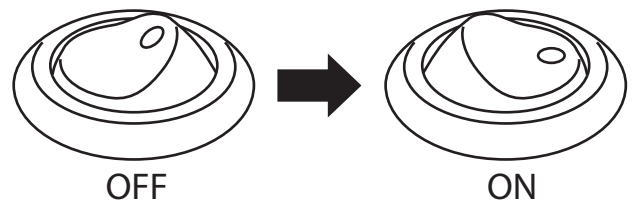

### 5 Activate the operation switch

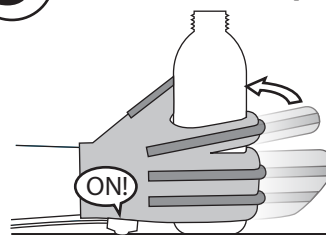

Press the operation switch against a surface such as a desk

\*See "How to Operate" in the Operation Manual