

electrical inlet 230V ~/13A/50Hz

J ↓

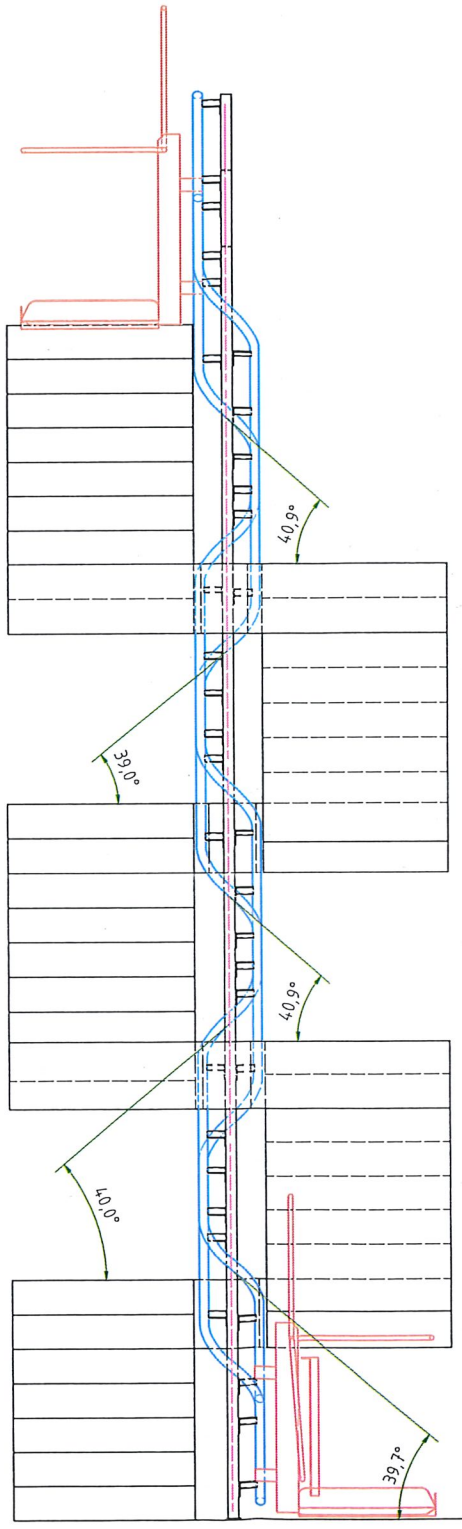

J (1 : 20)

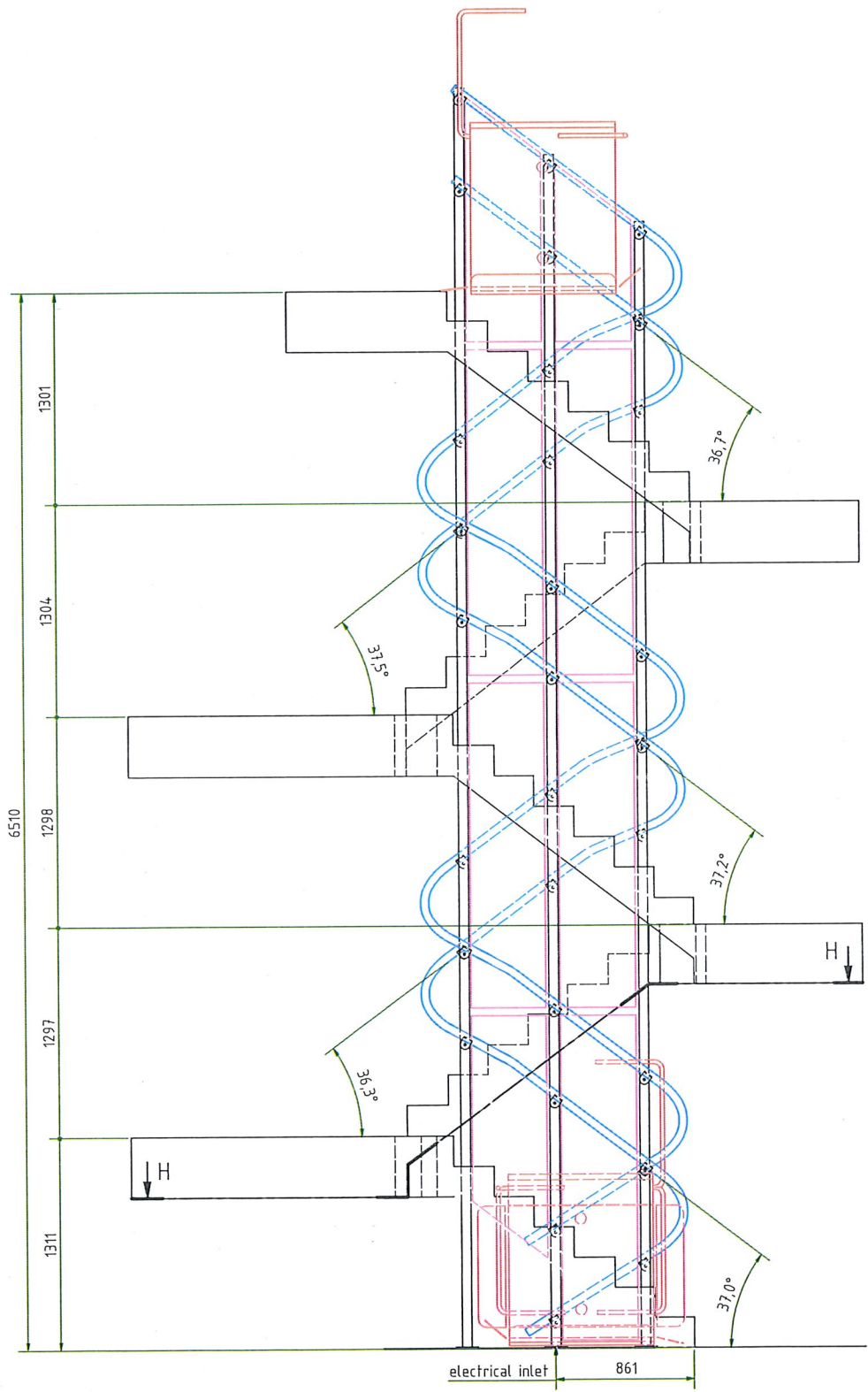
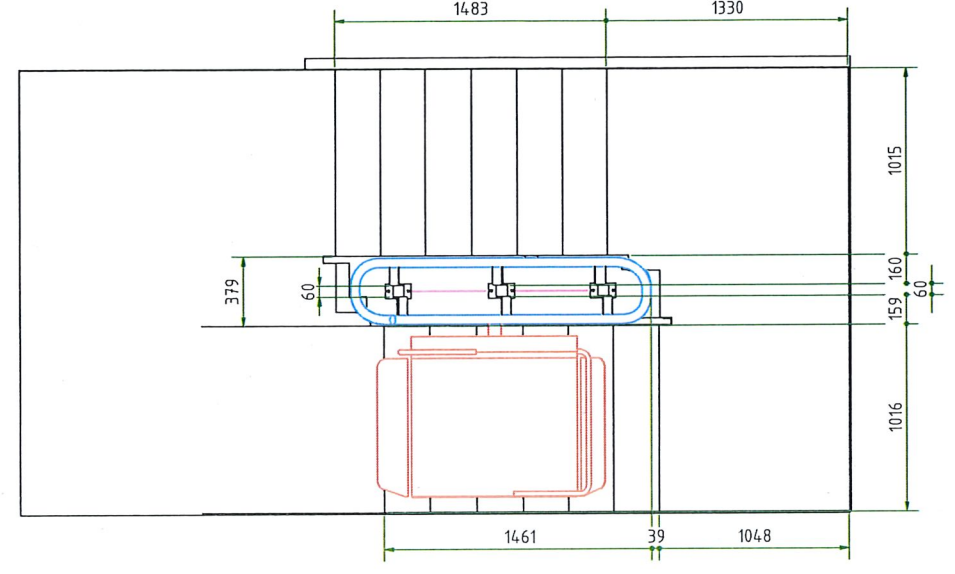

H-H (1 : 20)

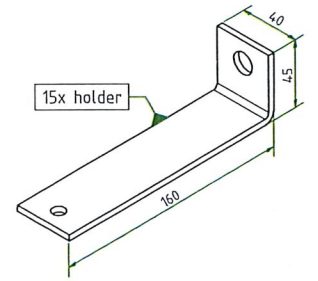
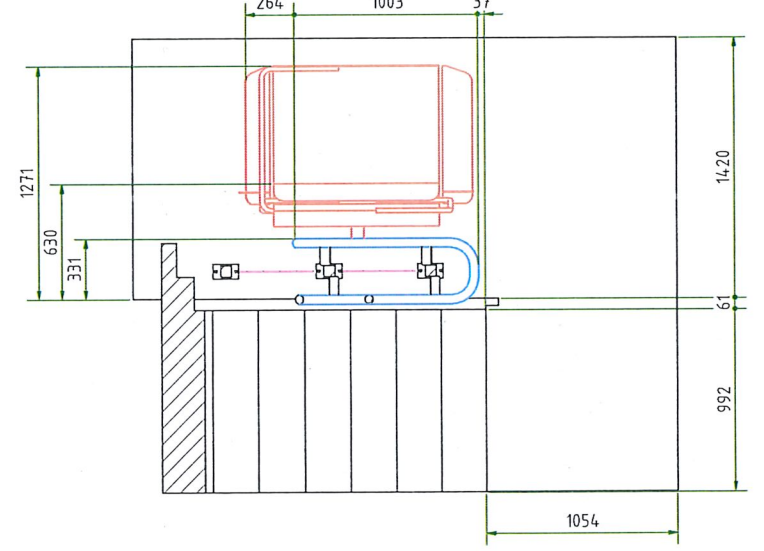

lift:
 GTL30 battery operated; indoor installation;
 platform 750x900; 300kg capacity; coated RAL.....

remote controller:
 2 pcs. hand-held-transmitter

installation:
 columns 60/60 in center RAL as lift
 holder +60mm
 aluminium sheet RAL as lift between columns

NO PROTECTION FOR THE GAP BETWEEN
 STEPS AND COLUMNS

| | | | |
|---|------------|--------------|---------|
| GANSER MASCHINEN AUSTRIA | | | |
| Markt 26, 4171 St. Peter am Wienberg Tel. +43 (0) 7262 6071-0 Fax +43 (0) 7262 6071-22 E-Mail: info@ganser/ital www.ganser/ital | | | |
| Date | Name | GTL30 | |
| 16.12.2015 | Pachträger | | |
| TKS | MATHISEN | | 1 A1 |
| Projekt Nr. 41093 | | | |

9 Minimum dimensions for various platform sizes

9.1 180° curve with inclination

| | 600x900 | 650x900 | 700x900 | 750x900 | 800x900 | 800x1000 | 800x1200 |
|---------------------------------|---------|---------|---------|---------|---------|----------|----------|
| A: platform closed [mm] | 395 | 395 | 395 | 395 | 395 | 395 | 395 |
| B: Plattform opend [mm] * | 886 | 936 | 986 | 1036 | 1086 | 1086 | 1086 |
| C: minimum staircase [mm] * | 1020 | 1060 | 1110 | 1150 | 1195 | 1220 | 1260 |
| D: minimum slewing range [mm] * | 1160 | 1200 | 1250 | 1290 | 1335 | 1360 | 1400 |

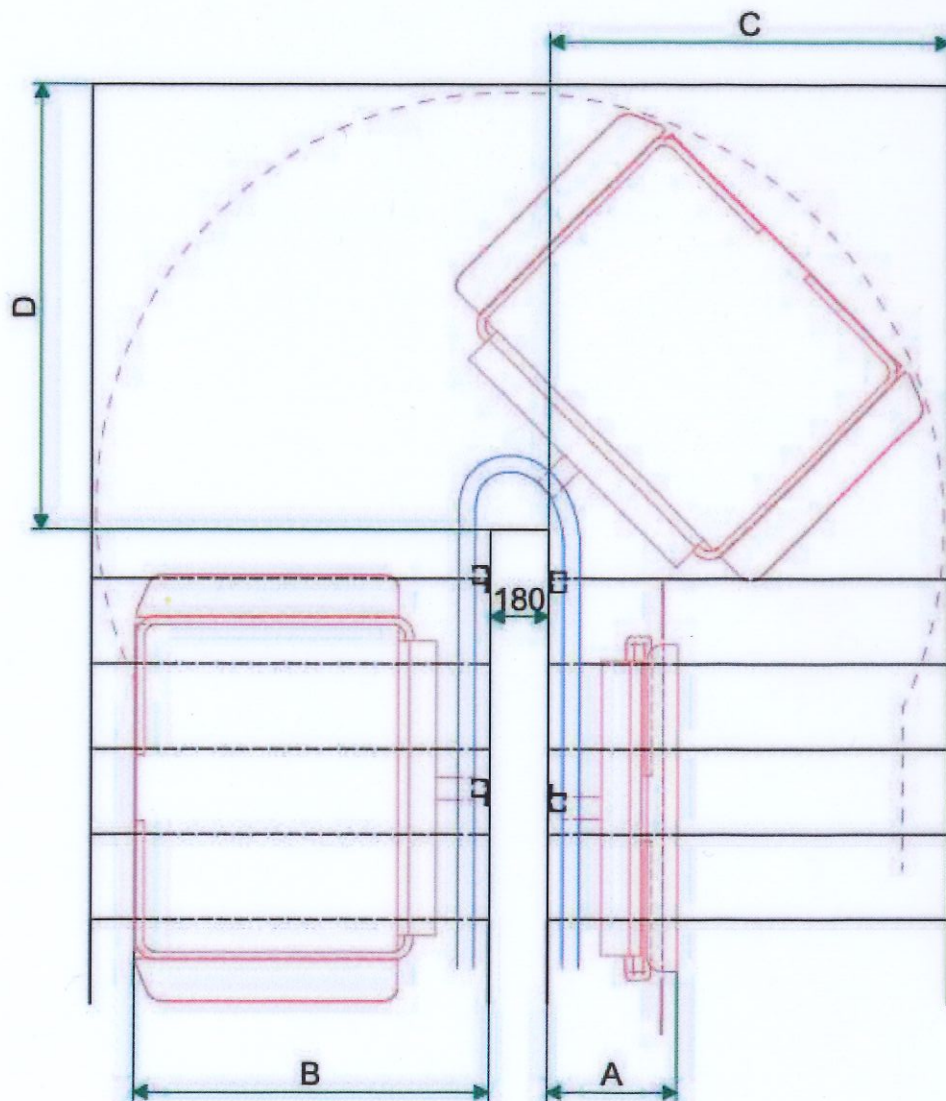

* with front ramp +100mm