

JOSI-Wismi G2 E-Drive

Rehab buggy

Instructions for use

for authorised dealers and users

Size	Art. No.	Drive system
Size S	JW-30002	Decon E-Drive
Size M	JW-30003	Decon E-Drive
Size L	JW-30004	Decon E-Drive

Videos



John GmbH
Ziddelrasen 1b
D-99830 Treffurt
+49 36923 8388-0
info@johngmbh.com
www.johngmbh.com



WE MANUFACTURE IN GERMANY 

Table of contents

1.	Introduction	3
2.	Accessibility of the instructions for use	3
3.	Intended use and indication	3
4.	CE conformity	3
5.	Combination JOSI-Wismi G2 – Decon E-Drive	4
6.	Locations for use	4
7.	Contraindications.....	4
8.	Safety instructions and application risks.....	4
9.	Setting up	5
10.	Folding	10
11.	Chassis settings	11
12.	Anti-tip and tipping lever	11
13.	Attendant and parking brakes	12
14.	Wrist safety line	12
15.	Front wheel.....	13
16.	Front wheel adapter and wheel change.....	14
17.	Footrest	15
18.	Seat angle adjustment (if equipped).....	15
19.	Backrest adjustment (if equipped)	15
20.	Adjusting the seat and backrest tension	16
21.	Seating system	17
22.	Seat width adjustment (if equipped)	18
23.	Abduction wedge Plus (if equipped).....	18
24.	Available belt systems.....	19
25.	Sun canopy with extension zips.....	22
26.	Rain cover & mosquito net (if equipped)	23
27.	Bag (if equipped).....	24
28.	Basket (if equipped)	25
29.	Leg cover (if equipped).....	25
30.	User transport in vehicles.....	26
31.	Maintenance and care.....	31
32.	Useful life and long-term durability	32
33.	Re-use.....	32
34.	Disposal	33
35.	Guarantee.....	33
36.	Reporting of serious incidents	33
37.	Technical data	33
38.	Type-label and symbols.....	35
39.	Manual Decon E-Drive.....	36

1. Introduction

JOSI-Wismi G2 E-Drive rehab buggy is a quality product from John GmbH. It is equipped with an integrated seat unit (upholstered cover) and optional seat angle and backrest adjustment. The seat depth and lower leg length are infinitely adjustable. Furthermore, the seating system can be equipped with additional components (lateral support, headrest, etc.). Many additional options can also be infinitely adjusted. JOSI-Wismi G2 E-Drive is ideally suited to ensure mobility outdoor and indoor, in urban and rural areas. With different front wheels, the buggy can be optimally adapted to individual needs, also when preparing the product for re-use. In this way, JOSI-Wismi G2 E-Drive adapts to all kinds of different conditions. **Before using JOSI-Wismi G2 E-Drive, please be sure to read all instructions for use very carefully. This will prevent damage due to operating errors and ensure optimum use of the JOSI-Wismi G2 E-Drive.**

We reserve the right of error and technical changes.

Images in this manual may differ in detail depending on the configuration.

2. Accessibility of the instructions for use

- These instructions for use can be provided as a PDF in the download area of our website www.johngmbh.com or on request.
- The content of these instructions for use should be understandable for all users. Many instructions are presented both in pictures and in simple language. Nevertheless, it is possible that the content may be unclear or difficult to understand. If this is the case, please contact John GmbH. We will be happy to advise you personally and at the same time check whether any content in the instructions needs to be changed.

3. Intended use and indication

JOSI-Wismi G2 E-Drive is a rehab stroller with electric drive, suitable for children and young people with a severe walking disability or inability to walk. In addition, JOSI-Wismi G2 E-Drive is "suitable for off-road use" and thus opens up the possibility of moving around in nature.

The variety of equipment options as well as the modular construction enable use in case of walking disability / inability to walk due to: high or low muscle tone, loss of limbs, limb defect and/or deformity, joint contractures, joint damage.

4. CE conformity

As the manufacturer, John GmbH declares under its sole responsibility that:

- JOSI-Wismi G2 E-Drive is a system in conformity with article 22 of the Regulation (EU) 2017/745 of the European Parliament and of the Council of the European Union.
- The system is a combination of the following CE medical devices:
 1. JOSI-Wismi G2
 2. Decon E-Drive 20" Big Ben version
- Both JOSI-Wismi G2 and Decon E-Drive are medical devices compliant with the requirements of Regulation (EU) 2017/745 (see the respective EU Declaration of Conformity).

5. Combination JOSI-Wismi G2 – Decon E-Drive

The combination of both medical devices JOSI-Wismi G2 with the Decon E-Drive has been approved by both manufacturers John GmbH and Decon AB.



A) Decon E-Drive 20" Big Ben Version

- incl. battery / battery bag and charger.

Attention!

- △ Note the chapter *Manual Decon E-Drive* for all safety instructions, operating instructions, technical data and guarantee conditions!
- △ Two anti-tip devices (left & right) must be mounted and used (see chapter *Anti-tip and tilting support*).

6. Locations for use

JOSI-Wismi G2 E-Drive is, depending on its configuration, suitable for outdoor and indoor use, in urban and/or rural areas on paved and unpaved roads.

7. Contraindications

- The maximum user weight, see chapter *Technical data*, must not be exceeded.

8. Safety instructions and application risks

- △ Before using the product, it is essential that a qualified person gives instructions on the safe and proper use of the product.
- △ All safety instructions must be followed in order to minimise safety risks.
- △ Caution, common sense and prudence are necessary to avoid unforeseeable situations or similar.
- △ Make sure you familiarise yourself with JOSI-Wismi G2 E-Drive before your first ride; driving characteristics and size (length, height and width).
- △ Watch your fingers during adjustment and assembly work.
- △ Be sure to observe the technical data (including the permissible user weight and payload).
- △ Follow the air pressure specifications for the tyres (see chapter *Technical data*).
- △ Make sure that all screw connections, locks and fasteners are tight.
- △ JOSI-Wismi G2 E-Drive is only authorised for the transport of **one** person.
- △ The option of an anti-tipper is strongly recommended (see chapter *Anti-tip and tipping lever*).
- △ For the transfer of the person transported, lock the parking brake.
- △ The person transported must always be secured with a belt system (see chapter *Belt systems*).
- △ Never leave the person transported unattended, even if they are secured by the seat belt and the brakes are locked.
- △ Always use the safety line on your wrist (see chapter *Wrist safety line*).
- △ When using the JOSI-Wismi G2 E-Drive, always use the anti-tipper if there is a risk of tipping over due to increased muscle tone or due to slopes or uneven paths, for example.
- △ A second anti-tipper is recommended if there is an increased risk of tipping.
- △ Always park the JOSI-Wismi G2 E-Drive on horizontal surfaces and firmly apply the parking brake.
- △ Make sure that the person transported does not lean out of the JOSI-Wismi G2 E-Drive. There is a risk of tipping or flipping over. If necessary, arms and legs must be positioned additionally.
- △ The use of spoke protectors (JW-35800 or comparable) is recommended.
- △ Use the rigid 12.5" front wheel or the 12.5" front wheel Pro on uneven paths.
- △ Pay attention to driving stability when travelling on inclines or uneven paths.
- △ Do not drive against obstacles.

- △ Only lift JOSI-Wismi G2 E-Drive by the frame. JOSI-Wismi G2 E-Drive must not be lifted by the push handle!
- △ Use access ramps or lifts. Stairs can only be climbed with the help of another person.
- △ Note the weight balance.
- △ Only hang the original bag on the push handle as described in the chapter *Bag*.
- △ Make sure that no parts hang out of the JOSI-Wismi G2 E-Drive during transport.
- △ Do not make any changes to the product.
- △ **A specialist dealer checks which components of the seating system are to be used for the user.**
- △ **All adjustments and readjustments – brakes, centre of gravity, seating system, belt adjustment, etc. – must be carried out by a specialist dealer.**
- △ **drum brakes must be serviced annually by a specialist dealer (see chapter *Maintenance and care*).**
- △ **All accessories that are not fitted must be fitted by a specialist dealer.**
- △ **If there is a defect or malfunction in the product or if you have any questions about the proper and safe use of the product, please contact your specialist dealer as soon as possible.**

8.1 Version with seat angle adjustment

- △ If possible, only operate the seat angle adjustment when there is nobody in the pushchair.

9. Setting up



Folded

9.1 Remove transportation strap



A) Open buckle

Open the wrist safety line (see chapter *Wrist safety line*) that keeps the JOSI-Wismi G2 E-Drive together when folded.

9.2 Back arch



A) Open back arch

Unfold the back.

B) Locking the back arch

Fold the back completely open and lock it by pressing lightly in the direction of the arrow.

Attention!

△ Make sure that the lock is fully engaged.

C) Adjust the backrest setting (if equipped)

See chapter *Backrest adjustment*.

9.3 Fold out foot section



A) Fold out until locking bolt engages

Lift the front part of the JOSI-Wismi G2 E-Drive slightly and fold out the foot section so that the locking bolt engages.



B) Screw in the lock

The snapped-in locking bolt must be additionally secured by turning it clockwise.



C) Pull the protective cover over the bolt

The protective cover protects the pivot bolt from dirt while driving.

Pull the cover over the pivot bolt.

9.4 Rear wheels

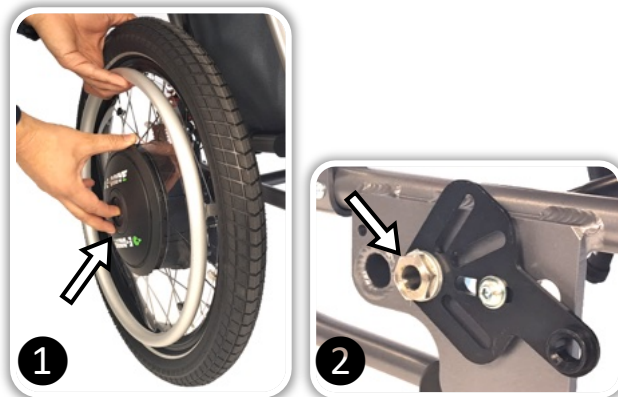

A) Fitting rear wheels

Push the quick release button **(1)** and insert the quick release axle into the axle holder **(2)**.

After you have completely inserted the quick release axle, the release can be loosened.

Please note:

Make sure that no foreign substances or dirt get on the axle and the axle support!

Attention!

⚠ Check that the quick release axle is correctly fitted. It must not be possible to remove the rear wheel without pressing the release.



B) Connecting plugs E-Drive

Connect the plugs from the battery cable (left and right) to the connectors of the wheel engines.

Please note:

For all instructions of the E-Drive, see chapter *Manual Decon E-Drive*.

9.5 Front wheel



A) Open cover

Open the cover in the foot area to reach the back of the adapter.



B) Mount the front wheel

Mount the front wheel.

See chapter *Front wheel adapter* for assembly instructions.



C) Close cover

Close the cover in the foot area.

9.6 Push handle



A) Adjusting the push handle

(1) Adjust the ergonomic push handle using the push buttons on the inside of the push handle joint.

(2) To gain space or to be able to hold the handle higher, the push handle can also be used in the upper position.

Attention!

- △ Only lift the JOSI-Wismi G2 E-Drive by the frame.
JOSI-Wismi G2 E-Drive must not be lifted by the push handle!
- △ Only hang the original bag on the sliding arch as described in the *Bag* chapter.
- △ Note the weight distribution.

9.7 Parking brake



A) Locking the parking brakes

Lock the parking brakes.

See chapter *Brakes and parking brakes* for instructions.

9.8 Anti-tip (if equipped)



A) Mount anti-tipper

- (1) Slide the anti-tipper into the rear of the frame and
- (2) secure it with the bolt.

B) Set anti-tipper (if equipped)

Adjust the anti-tipper.
See chapter *Anti-tip and tipping lever*.

9.9 Close covers

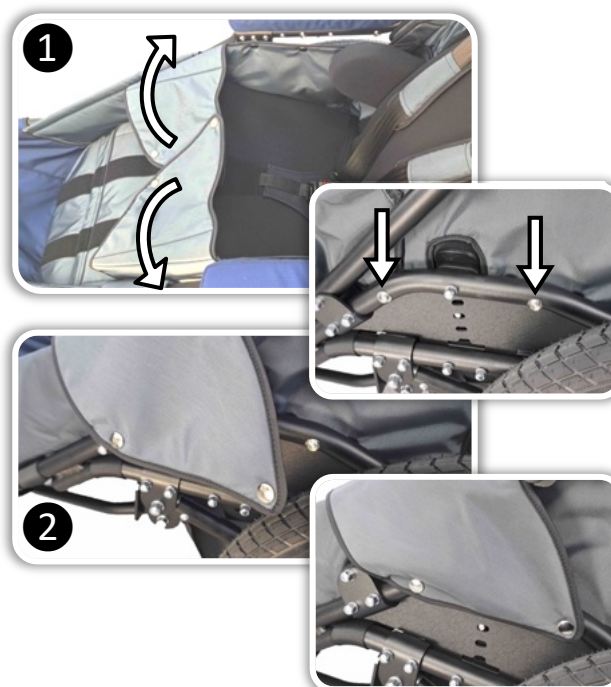
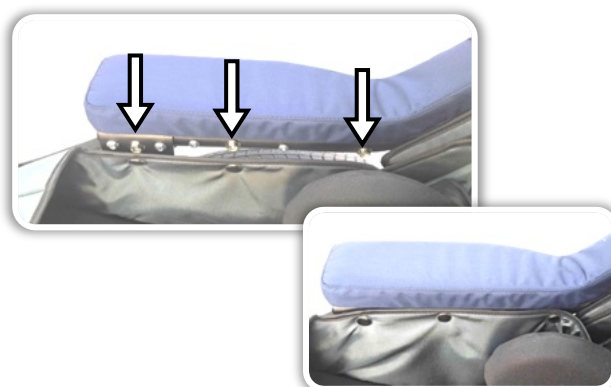

A) Inside cover folding mechanism

Use the press studs to close the covers on the inside.

B) Outside cover folding mechanism

- (1) Fold the left and right covers outwards.
- (2) Use the press studs to close the covers on the outside.



C) Safety cover

The safety cover prevents hands from getting between the back and side cover. Use the Velcro fastener to close the safety cover so that the brake cables (1) are under the cover.

10. Folding



A) Folding

- Fold the buggy in the following order:
1. Open the safety cover (Velcro)
 2. Open the covers of the folding mechanism (push buttons)
 3. Remove the anti-tipper (if equipped)
 4. Fold the push handle forwards (push buttons)
 5. Remove rear wheels (see chapter 10.1)
 6. Remove front wheel (adapter)
 7. Fold in foot area (locking bolt)
 8. Fold in the back (pull the lock)
 9. Open the backrest adjustment (if equipped), press it down and lock it again
 10. Attach the transportation strap to hold the folded frame together.

10.1 Removing rear wheels



A) Disconnecting plugs battery cable

1. Turn the twist lock of the plug
2. Pull the plug out of the connector (left and right)

Attention!

- △ Check that the quick release axle is correctly fitted. It must not be possible to remove the rear wheel without pressing the release.
- △ For all E-Drive instructions, see chapter *Manual Decon E-Drive*.



B) Removing rear wheels

1. Pressing the quick release axle.
2. Lift the JOSI-Wismi E-Drive a little bit at the armrest and pull the wheel out of the axle holder.

11. Chassis settings



A) Suspension

The spring stiffness can be adjusted using the adjustment ring (1) on the suspension. This makes it possible to adjust the suspension to the user's weight. By tensioning the spring (turn the adjustment ring clockwise), a higher preload is achieved and thus adapted to a higher weight. For a lower preload, the adjustment ring can be loosened (turn adjustment ring anti-clockwise).

Please note:

When loaded (JOSI-Wismi G2 E-Drive, user and luggage), the spring deflection (2) must not exceed 35% and should not fall below 17 mm.

Attention!

- ⚠ The adjustment ring must not be turned beyond the thread.
- ⚠ The spring must not sit loosely between the disc and the adjusting ring.

12. Anti-tip and tipping lever



A) Anti-tip and tipping aid

JOSI-Wismi G2 E-Drive is optionally equipped with a combined adjustable anti-tipper (1) with integrated tipping aid (2).

B) Mount

Insert the anti-tipper into the frame tube and secure it with the locking bolt.



C) Adjustment

The anti-tipper can be adjusted by pulling the lock.

Attention!

- △ When using the JOSI-Wismi G2 E-Drive, always use the anti-tipper if there is a risk of tipping over due to increased muscle tone or, for example, inclines or uneven surfaces.
- △ A second anti-tipper is recommended if there is an increased risk of tipping.

13. Attendant and parking brakes

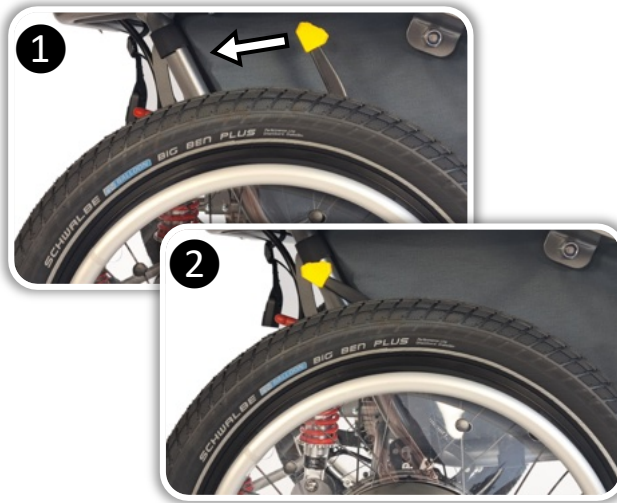

A) Attendant brakes

The attendant brakes work by the switched on E-Drive through the build in engine brakes. Pull the yellow levers **(1)** behind the wheels backwards into position **2** to switch off the freewheel and activate the engine.

B) Parking brakes

To activate the parking brake, switch of the E-Drive and put the yellow levers behind the wheels in position **2**.

Attention:

- △ For all E-Drive instructions, see chapter *Manual Decon E-Drive*.

14. Wrist safety line



A) Attach

The safety line should be attached to the push handle and your wrist.

Attention!

- △ Always use the safety line on your wrist.
- △ The safety line should not be too loose so that the wrist cannot slip out.

15. Front wheel

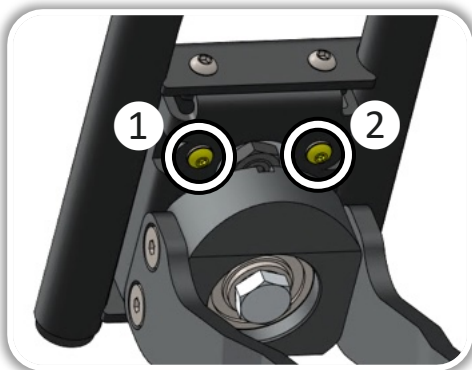
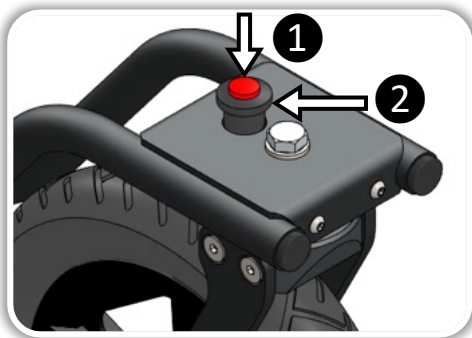

A) Available front wheels

JOSI-Wismi G2 E-Drive can optionally be equipped with the following pneumatic wheels:

- (1) 12.5" rigid front wheel
- (2) 12.5" swivel wheel Pro with locking function
- (3) 8" swivel wheel without locking function
- (4) 8" swivel wheel with locking function
- (5) Beach wheel

B) Locking function Swivel wheels (if equipped)

- (1) Press the red button to switch on the locking function.
- (2) Press the red button and pull the black lever at the same time to switch on the swivel function.

C) Adjust front wheel Pro (if equipped)

The front wheel Pro has the option of adjusting the directional stability.

Unscrew both screws (1 & 2), adjust the wheel mount and retighten the screws.

16. Front wheel adapter and wheel change

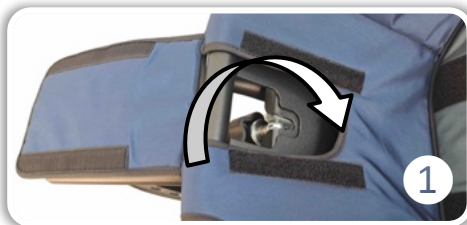

A) Open cover

Open the cover in the foot area to reach the back of the adapter.

B) Insert adapter

- (1) Insert the adapter on the lower side of the holder and
- (2) Place the adapter on the holder.

C) Locking screw

- (1) Fold up the locking screw,

- (2) Tighten the locking screw,

- (3) Close the cover in the foot area.

17. Footrest



A) Adjusting the footrest

The footrest can be adjusted to the length of the lower leg using the Velcro surface.

18. Seat angle adjustment (if equipped)

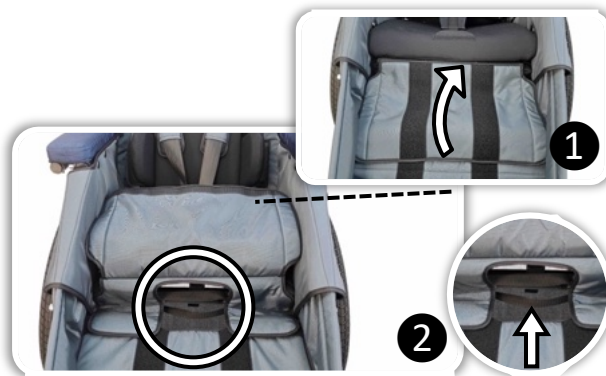

A) Open upholstery

Open the cover in front of the seat cushion (1) to reach the release strap of the seat angle adjustment (2).

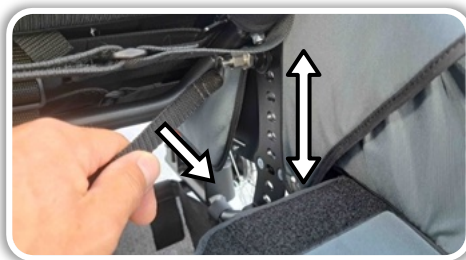

B) Pull the release strap

Pull the release strap of the seat angle adjustment and adjust the seat to the desired position.

Please note:

The seat angle can be adjusted approximately 30°.

19. Backrest adjustment (if equipped)



A) Quick-release levers

Hold the top of the back arch and unlock the quick-release levers (left and right).



B) Adjust the back

Adjust the back to the desired position.



C) Close quick-release levers

Close the two quick-release levers.

Attention!

△ Be sure to close both quick-release levers.

20. Adjusting the seat and backrest tension

20.1 Adjusting the seat tension



A) Adjusting the seat cushion straps

The individual seat cushion straps can be adjusted to different lengths depending on your requirements and body shape:

- (1) Lift up the seat cushion and adjust the seat cushion straps.
- (2) The Velcro straps on the belts should be in a line behind each other after adjustment (see dash line) so that the seat cushion attaches again.
- (3) Press the cushion back onto the Velcro.

20.2 Adjusting the backrest tension

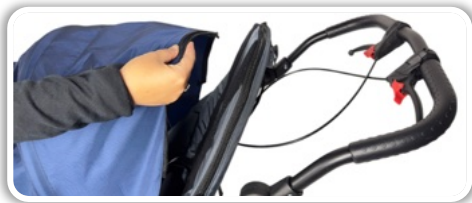

A) Open the sun canopy on the back

Open the sun canopy on the back side with the zip.



B) Open back

Open the back with the zip.



C) Adjusting the back straps

Adjust the individual back straps to the desired position and close the zips again.

Please note:

The individual back straps can be adjusted to different lengths depending on your wishes and body shape.

21. Seating system

21.1 Seat unit (basic equipment & available accessories)



A) Positioning components

The seat unit can be equipped with the following components for optimum seat positioning.

Components:

- (1) Padded backrest cover (basic equipment)
- (2) Headrest, adjustable with Velcro surface
- (3) Back cushion, variable height
- (4) Belt system, depending on requirements
- (5) Lateral support, adjustable width and height with Velcro
- (6) Arm covers (basic equipment) or armrests
- (7) Seat width adjustment
- (8) Abduction wedge
- (9) Seat cushion, depth adjustable with Velcro (basic equipment)
- (10) Footrest, adjustable to lower leg length (basic equipment)

21.2 Back cushion

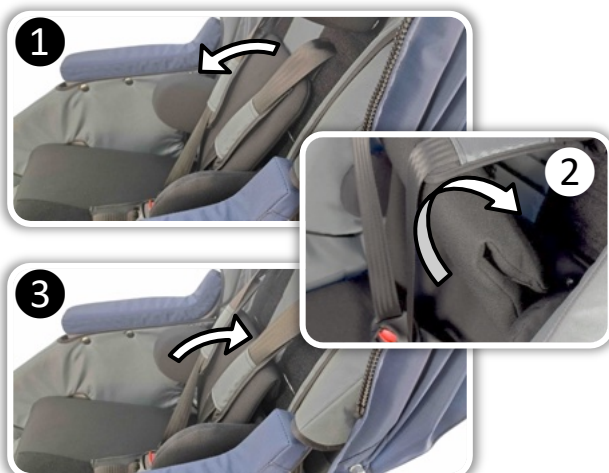

A) Back cushion variable height

The back cushion has a variable height:

- (1) Pull the back cushion forwards out of the Velcro
- (2) Fold the back cushion backwards on the upper and/or the lower side to the desired height and velcro it to the inside.
- (3) Place the back cushion against the back again.

21.3 Adjusting the seat depth



A) Lift cushion

Lift up the seat cushion.

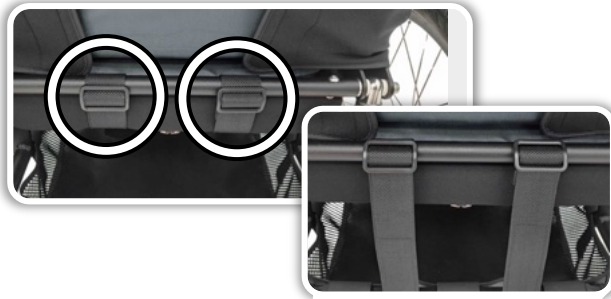

B) Open Velcro straps at the back

Open the two Velcro straps on the back of the cushion. These straps hold the back of the cushion in position.



C) Adjust the seat depth

Adjust the seat depth and press the cushion onto the Velcro fasteners.



D) Close the Velcro straps at the back

Place the Velcro straps around the back of the cushion again. Close the straps under slight tension on the Velcro underneath the cushion.

22. Seat width adjustment (if equipped)



A) Seat width

The side guides allow the seat width to be reduced by either 12 cm or 18 cm. The wedges can be attached in two different positions using Velcro.

23. Abduction wedge Plus (if equipped)



A) Firmly screwed in place, depth adjustable

The Abduction Wedge Plus is a stable, firmly screwed version with a dimensionally stable core in a black finish. In contrast to the Velcro-compatible, soft-padded abduction wedge, this model offers increased stability and secure fixation. The wedge is individually adjustable in depth and can be removed without tools if required.

24. Available belt systems

24.1 5-point belt

24.1.1 Belt height

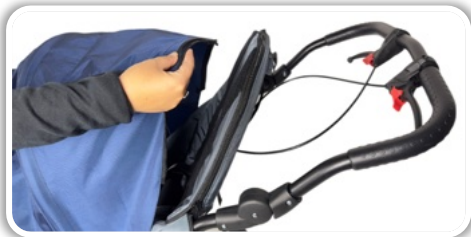

A) Open the sun canopy on the back

Open the sun canopy on the back side with the zip.



B) Open the back

Open the back with the zip to access the belt connector **(1)**.



C) Unhook the belt connector

Unhook the belts from the belt connector and guide them forwards through the back.



D) Insert the belts

Insert the belts through the desired slits and pull them through.

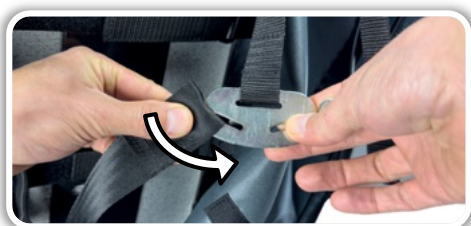

E) Hook into the belt connector

Hook the belt back into the belt connector and check that it is correctly seated.



F) Refit the backrest & sun canopy

Close the back and the sun canopy again with the zips.

24.1.2 Belt length

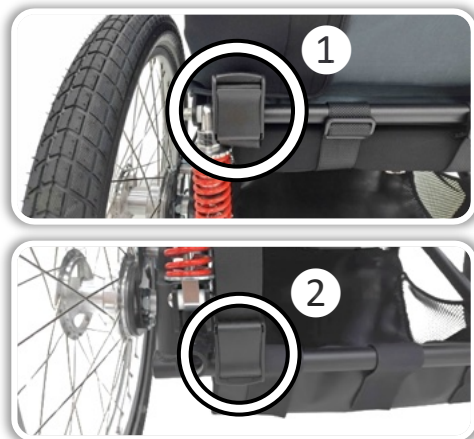

A) Adjusting the belt length

Depending on the version, you can adjust the belt length using the belt buckles above **(1)** or below **(2)** the suspension:

- Unlock the belt adjuster.
- Adjust the belt to the desired length.
- Close the belt adjuster.

24.1.3 Fasten the belt



A) Fastening the 5-point belt

Fasten the 5-point belt as follows:

The upper belts have to be routed over the shoulders and the lower straps over the thighs.

Please note:

The belt pads are equipped with velcro to keep them in position.

Attention!

- △ Make sure that the belt pads are positioned directly on the shoulder.



B) Closing the belt buckle

(1) Place the two push-in lock parts on top of each other.

(2) Insert the combined buckle parts into the belt buckle.

Please note:

- The belt can be opened by pressing the red button.
- If the belt is too short, adjust the belt length (see section *Belt adjuster*).

24.1.4 Belt adjuster



A) Shorten belt length

Adjust the belt by pulling the adjustment strap on the rear side of the back.

Attention!

- △ Adjust the belt system so that it fits close to the body and provides sufficient support.
- △ At the same time, make sure that the belts are fastened in such a way that the user can breathe freely.

B) Extend belt

To extend the belt, press the release and pull the front of the strap.

24.2 Pelvic belt / Chest-shoulder belt / seat trousers



A) Belt systems

The following belt systems can alternatively be attached to the JOSI-Wismi G2 E-Drive:

- (1) Chest-shoulder belt
- (2) Pelvic belt
- (3) Seat trousers

24.2.1 Fastening the belts



A) Pelvic belt, seat trousers and lower side chest-shoulder belt

Attach the pelvic belt, the seat trousers and/or the lower straps of the chest-shoulder belt with the belt buckles above (1) or below the suspension (2) (depending on the configuration).



B) Chest-shoulder belt upper side

- (1) Open the sun canopy on the back side with the zip.
- (2) Open the back with the zip.
- (3) Guide the upper straps of the chest-shoulder belt through the desired slits.
- (4) Fasten the upper straps of the chest-shoulder belt crosswise to the upper back arch.
- (5) Attach the upper straps of the chest-shoulder harness to the upper back arch using the folding buckles.
- (6) Close the backrest and sun canopy again with the zips.



C) Seat trousers fastening straps

Wrap the two fastening straps around the arch of the back. Close the two straps with the buckle and adjust the correct belt length.

25. Sun canopy with extension zips

25.1 Sun canopy Basic



A) Opening and closing

- (1) Open the sun canopy and close the magnetic catch.
- (2) Lift up the magnetic catch to close the sun canopy.



B) Zip on the front side

The sun canopy base has a zip at the front for attaching the following extension accessories:

- Extension for sun canopy
- Mosquito net
- Rain cover

25.2 Sun canopy Plus



A) Sun canopy Plus with coverable window and two extension zips

The sun canopy Plus is equipped with:

- (1) A coverable window.
- (2) Two extension zips on the front.

The following extension accessories can be attached to one of the zips (maximum two at a time):

- Extension for sun canopy
- Mosquito net
- Rain cover

25.3 Extension for sun canopy (if equipped)



A) Extension of the sun canopy

The extension is attached to the sun canopy with the zip.

26. Rain cover & mosquito net (if equipped)



A) Rain cover & mosquito net

The rain cover and the mosquito net are attached to the JOSI-Wismi G2 E-Drive in the same way.



B) Attachment to the sun canopy

Attach the rain cover / mosquito net to the sun canopy using the zip.



C) Front attachment

Place the rain cover or mosquito net over the front frame.

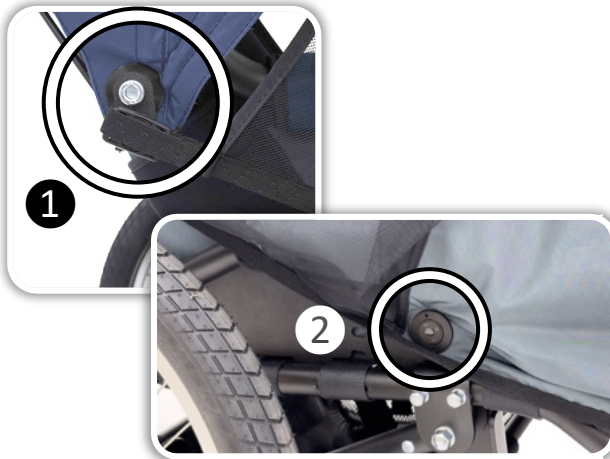

D) Lateral attachment

- (1) Attach the magnetic fastener to the pivot point of the sun canopy.
- (2) Attach the magnetic fastener underneath the arm pads or armrests.

27. Bag (if equipped)



A) Attach the upper side

Hang the bag over the push handle.



B) Attach the lower side

Attach the magnetic fastener to the frame at the bottom corner of the bag.

28. Basket (if equipped)



A) Basket underneath the seat

The basket underneath the seat offers space for items such as a changing bag, shopping or clothing.



B) Basket can be reached through the seat angle adjustment (if equipped)

If the seat angle adjustment is equipped, the basket can be reached from above by opening the seat angle adjustment:

- (1) Open the Velcro cover to access the seat angle adjustment.
- (2) Unlock the seat angle adjustment and lift the seat up.

29. Leg cover (if equipped)



A) Attachment via the Velcro surface

Lift up the seat cushion and fasten the leg cover with the Velcro between the seat cushion and the front strap.

30. User transport in vehicles

30.1 General information

- △ This chapter refers to the transport of users in the JOSI-Wismi G2 E-Drive in authorised vehicles with four-point seat belt wheelchair restraint systems.
- △ We point out that the safest way to transport users is on the fixed vehicle seat. Whenever possible, users should transfer to the fixed vehicle seat, use the original car seat belts installed in the vehicle and secure the folded JOSI-Wismi G2 E-Drive in the vehicle's load compartment. However, there are users who cannot be transported in the permanently installed vehicle seats and are dependent on wheelchair transport in a suitable vehicle.
- △ Section *Approved JOSI-Wismi G2 E-Drive model variants for transport in vehicles* lists the model variants of the JOSI-Wismi G2 E-Drive that are approved for transport in vehicles. These model variants fulfil the requirements of ISO 7176-19:2022-04 "*Wheelchairs for use as seats in motor vehicles*" (hereinafter ISO 7176-19).
- △ The JOSI-Wismi G2 E-Drive should **always** be used as a seat in a motor vehicle facing forwards in the direction of travel. It should be noted that a wheelchair with the shortest possible turning radius generally allows easier access to the vehicle and better manoeuvrability in a forward-facing position.
- △ To transport users in the JOSI-Wismi G2 E-Drive in a vehicle, you **always** need the fastening kit for transport in the vehicle, Art. No. JW-32800 (see order form). This article number contains all the accessories required for transport in vehicles (see section *Application of JOSI-Wismi G2 E-Drive for user transport in vehicles*). The vehicle must be equipped with a four-point wheelchair restraint system approved in accordance with ISO 10542. Only this combination of the JOSI-Wismi G2 E-Drive has been tested and approved in accordance with ISO 7176-19.
- △ The three-point belt restraint system in the vehicle (diagonal shoulder belt) can be easily connected to the integrated red lap belt of the power belt system in the JOSI-Wismi G2 E-Drive. Depending on its position in the vehicle, the belt can be fastened over either the right or left shoulder (see section *Application of JOSI-Wismi G2 E-Drive for user transport in vehicles*).
- △ To attach the JOSI-Wismi G2 E-Drive on the vehicle, only use the attachment points provided on the JOSI-Wismi G2 E-Drive. The attachment points at the front are mounted on the front attachment of the rear axle and at the rear on the lower attachment of the suspension and are labelled with the following symbol (see section *Application of JOSI-Wismi G2 E-Drive for user transport in vehicles*): 
- △ This chapter on transport in vehicles **does not refer** to the transport of JOSI-Wismi G2 E-Drive users in public transport. John GmbH does not impose any additional requirements on the product for the transport of JOSI-Wismi G2 E-Drive users on public transport. However, be sure to always observe the respective requirements and authorisations of the individual transport companies and their individual vehicles.

30.2 Approved JOSI-Wismi G2 model variants for transport in vehicles

Only the following models of the JOSI-Wismi G2 E-Drive are approved for the transport of users with a maximum body weight of 70 kg and comply with ISO 7176-19 requirements:

Model	Art. no. JOSI- Wismi G2	Equipment (see order form)	Product weight* ¹	Max. User weight incl. payload
JOSI-Wismi G2 size S	JW-30002	<ul style="list-style-type: none"> • 8" front swivelling wheel with locking function • 20" rear wheels with tire size 20 x 2.15" • Fastening kit transport in vehicles 	29.5 kg	50 kg
JOSI-Wismi G2 size S* ²	JW-30002	<ul style="list-style-type: none"> • Decon E-Drive • 8" front swivelling wheel with locking function • 20" rear wheels with tire size 20 x 2.15" • Fastening kit transport in vehicles 	44.5 kg	50 kg
JOSI-Wismi G2 size M* ³	JW-30003	<ul style="list-style-type: none"> • 8" swivelling wheel with locking function • 20" rear wheels with tire size 20 x 2.15" • Fastening kit transport in vehicles 	31.5 kg	70 kg
JOSI-Wismi G2 size M* ²	JW-30003	<ul style="list-style-type: none"> • Decon E-Drive • 8" swivelling wheel with locking function • 20" rear wheels with tire size 20 x 2.15" • Fastening kit transport in vehicles 	46.5 kg	70 kg

△ **All other models/variants** (JOSI-Wismi G2 size L, article number JW-30004 and models with front wheels other than 8" with locking function and other rear wheels than 20 x 2.15") are **NOT authorised for transport in vehicles.**

*¹ Exact weight of the respective configuration of the JOSI-Wismi G2.

*² The combination of the JOSI-Wismi G2 with the Decon E-Drive has been recognised by both John GmbH and the approved by Decon AB for transport in vehicles.

*³ This model variant of the JOSI-Wismi G2 in size M has been successfully crash-tested in accordance with ISO 7176-19 and is the most heavily authorised model variant. As it is unfortunately not possible to test all model variants individually, the so-called "worst case" was tested. All other models listed are lighter than the model variants tested. They have the same design with the same dynamic properties and are therefore also approved by John GmbH for transport in vehicles. The size L and all models with front wheels other than 8" with locking function have **not** been crash tested and are excluded from transport in vehicles.

30.3 Warning and safety instructions for transport in vehicles

Please observe the following warnings and safety instructions when transporting in vehicles:

△ In the vehicle, always use at the same time the integrated red-coloured lap belt of the fastening kit for transport in vehicles in the JOSI-Wismi G2 E-Drive, the diagonal shoulder belt fitted in the vehicle and a four-point wheelchair restraint system approved in accordance with ISO 10542 to reduce the possibility of head and chest impact with vehicle parts.

△ **Be sure to read the section *Application of JOSI-Wismi G2 E-Drive for user transport in vehicles.***

△ **Be sure to read the additional instructions for use for the power knot system (AMF-Bruns).**

△ Always position the JOSI-Wismi G2 E-Drive forwards in the direction of travel and apply the parking brakes.

△ The approved JOSI-Wismi G2 E-Drive model variants for transport in vehicles comply with the requirements of ISO 7176-19 and have been designed and dynamically tested for use as a forward-facing-seat in a motor vehicle, with the test dummy secured with a three-point seat belt.

△ Activate the locking function of the 8" swivel wheel (see section *Application of JOSI-Wismi G2 E-Drive for user transport in vehicles*).

△ Move the push handle to the foremost position (see section *Application of JOSI-Wismi G2 E-Drive for user transport in vehicles*).

- △ If the backrest adjustment is mounted, it must be moved to the upper position and fixed with the safety bolts (see section *Application of JOSI-Wismi G2 E-Drive for transport in vehicles*).
- △ The adjustable footrest may remain in the set position.
- △ Loose parts should **not** be left in the JOSI-Wismi G2 E-Drive during transport in vehicles and must be removed and stowed safely.
- △ No objects may be left in the basket (if equipped).
- △ The bag on the push handle (if equipped) must be removed.
- △ Custom made products for the JOSI-Wismi G2 E-Drive (e.g. therapy table or mounted tablet) are **not** approved for transport in vehicles and must be removed and safely stowed away.
- △ Other aids and/or accessories attached to the JOSI-Wismi G2 E-Drive are also **not** authorised for transport in vehicles and must be removed and stowed safely.
- △ All head support variants for the JOSI-Wismi G2 E-Drive and the abduction wedge are **not** approved for transport in vehicles and must be removed and stowed safely.
- △ All other JOSI-Wismi G2 E-Drive seating positioning accessories available in the order form comply with the requirements of ISO 7176-19 and may be used for transport in vehicles.
- △ The belt systems for the seat positioning of the JOSI-Wismi G2 E-Drive may be used during transport in vehicles. These belt systems are **not** a substitute for the occupant restraint system. The red-coloured lap belt and the shoulder belt of the vehicle must always be used when transporting in a vehicle.
- △ Users in the JOSI-Wismi G2 E-Drive should **not** be transported in the vehicle if modifications or additions have been made to the attachment points of the JOSI-Wismi G2 E-Drive, to the structure and frame parts or to components.
- △ Users in the JOSI-Wismi G2 E-Drive may **not** be transported in the vehicle if there is a defect.
- △ The JOSI-Wismi G2 E-Drive must be taken out of service if it has been involved in an accident.
- △ If a Decon E-Drive is mounted on the JOSI-Wismi G2 E-Drive, it must be switched off or the battery must be removed during transport in vehicles.
- △ If an ENJO drive is mounted on the JOSI-Wismi G2 E-Drive, it must be removed from the JOSI-Wismi G2 E-Drive and stowed safely during transport in vehicles.
- △ When putting on the diagonal shoulder belt and the wheelchair restraint system, make sure that the belt buckle is positioned so that the release button will not be contacted and opened by components of the JOSI-Wismi G2 E-Drive during a crash.
- △ The Belt restraint system should **not** be held away from the body by parts of the JOSI-Wismi G2 E-Drive such as frame or wheels.
- △ The belts should **not** be twisted.
- △ The diagonal shoulder belt and the red-coloured lap belt integrated in the JOSI-Wismi G2 E-Drive should make full contact with the shoulder, chest and pelvis. The red-coloured pelvic belt must be positioned between upper thigh and abdomen (see section *Application of JOSI-Wismi G2 E-Drive for user transport in vehicles*).

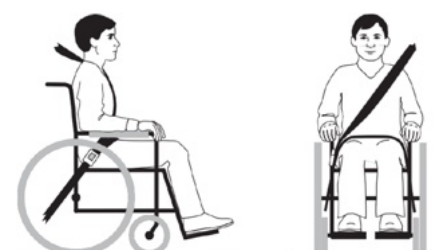
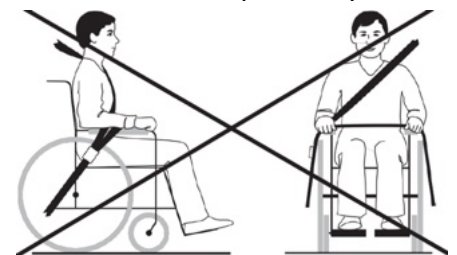

30.4 Application of JOSI-Wismi G2 E-Drive for user transport in vehicles



A) Fastening kit for transport in vehicles

The JOSI-Wismi G2 E-Drive is only approved for transport in vehicles in the authorised configurations if the mounting kit for transport in vehicles (article number JW-32800) is fully mounted:

- (1) Power knot system Fa. AMF-Brunns including attachment points with sticker "*attachment point restraint system*" and red-coloured lap safety belt.
- (2) Sticker "*Conformity with ISO 7176-19*" on the frame tube between the two rear axle plates.
- (3) 2 x safety bolt for the backrest adjustment (if equipped).



B) Push handle forwards

The push handle of the JOSI-Wismi G2 E-Drive should be turned completely forwards and serves as an extra safety bar for the head.

Attention!

△ The plastic joints (1) must be engaged.



C) Secure backrest adjustment (if equipped)

The backrest adjustment (if equipped) must be moved to the top position and secured with the safety bolts.



D) Activate locking function 8" swivel wheel

Activate the locking function of the 8" swivel wheel so that the swivel function is blocked. Set the swivel wheel to the straight position and press down the red button.

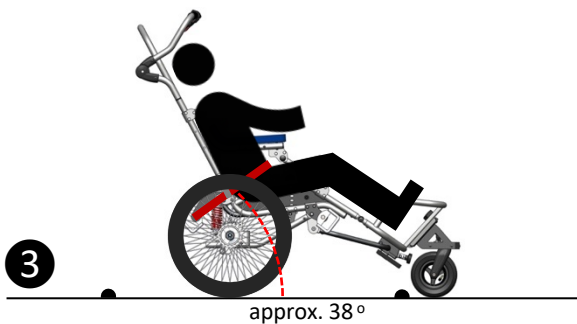

E) Integrated red-coloured lap belt

The integrated red-coloured lap belt must always be used during transport in vehicles:

- (1) Place the belt around the user's pelvis and close the buckle.
Tighten the belt so that it fits close around stomach and thighs.
- (2) Place the black belt system of the JOSI-Wismi G2 E-Drive over the red-coloured lap belt. The black belt system is **not** a safety belt for transport in vehicles and is only used to position the user in the seat.
- (3) The red-coloured integrated lap belt is mounted directly on the JOSI-Wismi G2 E-Drive's power knot system at an angle of approx. 38° to the horizontal and is inserted between the backrest cushion and the seat cushion. This fulfils the requirements of ISO 7176-19; between 30° and 75° to the horizontal.

Please note:

It is recommended that you fasten the red-coloured lap belt before driving the JOSI-Wismi G2 E-Drive into the vehicle.

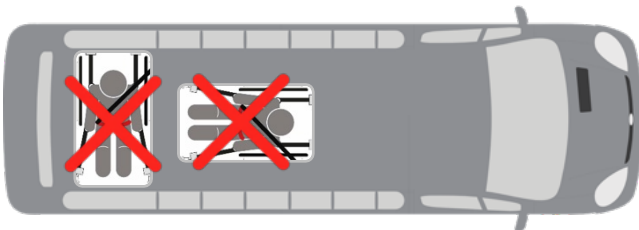
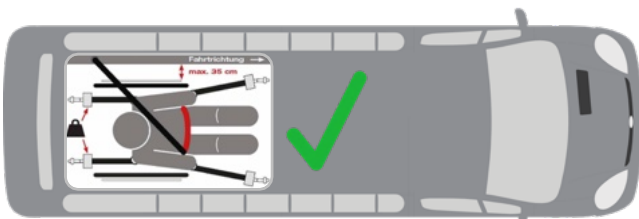

F) Forward in direction of travel

Drive the JOSI-Wismi G2 E-Drive forwards in the direction of travel in the vehicle with restraint system, approved according to ISO 10542, suitable for transporting people in a wheelchair.

Attention!

- △ The JOSI-Wismi G2 E-Drive must always be positioned facing forwards in the direction of travel and at a maximum distance of 35 cm from one of the side walls of the vehicle.

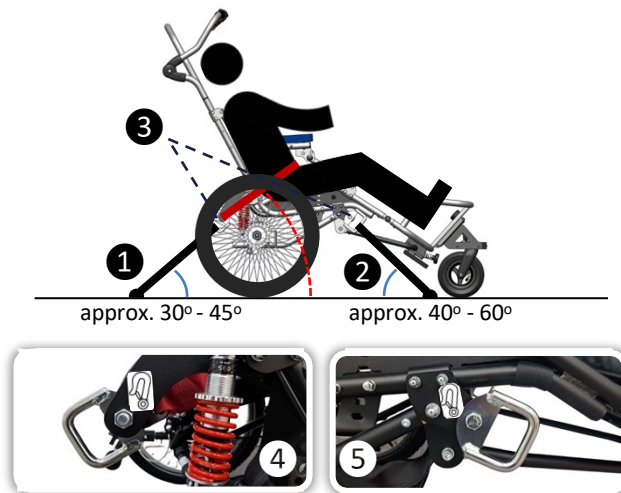

G) Wheelchair restraint system

The straps (1) and (2) of the four-point wheelchair restraint system must be attached to the attachment points provided on the JOSI-Wismi G2 E-Drive's power knot system (3), at a maximum angle of 30° - 45° (1) to the horizontal at the rear and 40° - 60° (2) at the front.

Please note:

The attachment points on the JOSI-Wismi G2 E-Drive are mounted behind the suspension (4) and on the front attachment of the lower frame (5) and are labelled with the following symbol:

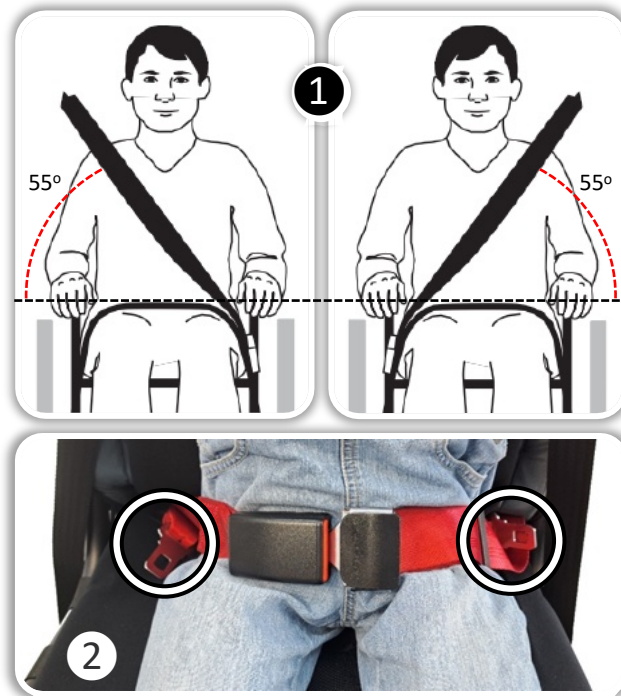

H) Shoulder diagonal belt

- (1) Position the diagonal shoulder belt close to the body, in the centre of the shoulder and over the centre of the sternum. The diagonal shoulder belt should have an angle of approx. 55° to the horizontal. Depending on its position in the vehicle, the belt can be fastened over either the right or left shoulder.
- (2) Connect the vehicle's diagonal shoulder belt to the right or the left buckle tongue of the red-coloured lap belt, depending on its position in the vehicle.

Attention!

- △ The belt should not be twisted during use.
- △ The belt should be adjusted as close to the body as possible but should not affect the user's comfort.

31. Maintenance and care

31.1 Technical inspection

For the technical inspection, following must be noted:

• Visual inspection, e.g. for damage:	before each trip
• Belt system adjustments and buckle:	before each trip
• Brake test:	before each trip
• Connections, locks, clamp connections:	before each trip
• Air pressure of the tyres:	weekly, before each trip
• Wear parts (including wheels, bearings, tyres, brakes, bowden cables), brake levers, parking brakes, hinges, clamp connections, locks):	monthly
• Screw connections:	monthly
• Decon E-Drive	See <i>Manual Decon E-Drive</i>

If there are any defects, you must contact your specialist dealer to have them rectified.

31.2 Drum brake maintenance

The drum brakes must be checked and adjusted by a specialist dealer at least once a year or if a defect in the braking performance (parking brake and attendant brake) is detected. If insufficient adjustment can be made, the brake linings must be replaced.

31.3 Maintenance kit

We recommend having the hinges, clamp connections, suspension and folding mechanism replaced by a specialist dealer every two years. Use the respective maintenance kit which you can obtain by stating the serial number of the JOSI-Wismi G2 E-Drive.

31.4 Care and cleaning instructions

The frame can be cleaned with commercially available cleaning agents. All fabrics can be washed with warm water and disinfected with commercially available disinfectants for textiles and surfaces (NO chlorine!). Store your JOSI-Wismi G2 E-Drive in a dry, well-ventilated place. Before storage, JOSI-Wismi G2 E-Drive should be dry to avoid mould and the formation of mildew stains. Expose JOSI-Wismi G2 E-Drive to direct sunlight as little as possible to prevent the colours from fading.

32. Useful life and long-term durability

The useful life of JOSI-Wismi G2 E-Drive is set by the manufacturer at 5 years. With regular and proper care, maintenance and repair by the manufacturer, the service life of JOSI-Wismi G2 E-Drive **(with the exception of the authorisation for vehicle transport)** can be extended depending on the intensity of use.

JOSI-Wismi G2 E-Drive is made of corrosion-protected material (see materials used chapter *Technical data*). The product has parts or components that are subject to natural wear and tear even with normal use, but this is very much dependent on the individual type and intensity of use as well as the maintenance and care. Particularly in case of intensive use (daily use in all weather conditions or similar), individual parts or components may reach their wear limit even before the legal warranty period and/or the specified useful life have expired. In these cases of premature wear due to use, however, there is not automatically a defect in the product. Reaching the wear limit is influenced by, among other things:

- the mileage in km
- the load caused by: person transported and luggage
- user environment
- the influence of the weather: UV radiation
- humidity
- dirt
- temperature
- salty air
- contact with salt water
- roads strewn with salt
- storage
- the state of maintenance

33. Re-use

The product is only suitable for reuse if the safety and characteristics of the product have not changed as a result of previous use.

The aluminium tube frame is corrosion-resistant due to its powder coating. All screw connections and joints are corrosion resistant. Even if the powder coating is damaged, no corrosion can occur due to the aluminium construction. In general, it is recommended to have JOSI-Wismi G2 E-Drive serviced by the manufacturer before using it again.

For reuse, the condition of use and the safety of the product must be checked and ensured by the specialist dealer using the checklist for delivery, maintenance and reuse (available from the manufacturer). Wear parts should be replaced before reuse.

The cleaning and disinfection of the product must be carried out according to the cleaning instructions. For hygienic reasons, padding parts that come into direct contact with the skin must be replaced when the product will be re-used.

34. Disposal

The product must be disposed of in accordance with the respective national legal requirements.

35. Guarantee

35.1 Guarantee JOSI-Wismi G2

The following guarantee conditions apply to manufacturing and material defects:

- 2 years general guarantee on the product (except wearing parts).
- 3 years on the aluminium frame
(Sliding marks can occur on the powder coating at all sliding and connection points).
- The guarantee conditions of the Decon electric drive (if equipped) can be found in the product manual.

35.2 Guarantee Decon E-Drive

See Chapter *Manual Decon E-Drive*

36. Reporting of serious incidents

All serious incidents occurring in connection with the products must be reported to the manufacturer (John GmbH) and the competent authority.

„*Serious incident*“ means any incident that directly or indirectly led, might have led or might lead to any of the following:

- the death of a patient, user or other person;
- the temporary or permanent serious deterioration of a patient's, user or other person's state of health;
- a serious public health threat – an event which could result in imminent risk of death, serious deterioration in a person's state of health, or serious illness, that may require prompt remedial action, and that may cause significant morbidity or mortality in humans, or that is unusual or unexpected for the given place and time.

(Regulation (EU) 2017/745)

37. Technical data

37.1 Materials used

Tubular frame	Aluminium round tube, AlMgSi0.5/EN AW-6060 T66, powder-coated
Laser edged parts	Aluminium AlMg3, powder-coated
Turned/milled parts	AW6082-AlSi1; 1.4301-A2; PVC-CAW
Screws and fastening material	Stainless steel A1/ A2; galvanised steel 10.9
Cover fabric	"Supratex" nylon fabric PU-coated
Rear joint cover	Neoprene; 1,5 mm laminated on both sides with single jersey
Upholstery	Polyether foam
Belts	Polyester webbing; polyamide hook/loop webbing
Wheels	Plastic or aluminium rim with pneumatic tyres

37.2 Dimensions and weights

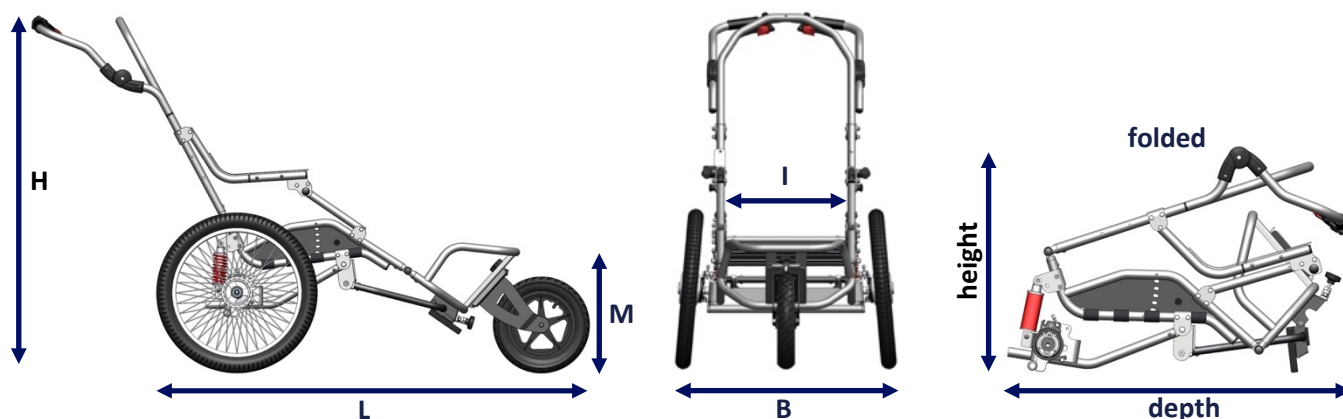

JOSI-Wismi G2 E-Drive Article number	Size S JW-30002	Size M JW-30003	Size L JW-30004
Body size	approx. 105 - 145 cm	approx. 125 - 165 cm	approx. 150 - 185 cm
Height: H	114 cm	120 cm	125 cm
Length: L	see next table	see next table	see next table
Passage width: B	78,5 cm	83,5 cm	88,5 cm
Inside / seat width: I	up to 36 cm	up to 42 cm	up to 47 cm
Seat height: M (incl. cushion)	43 cm	43 cm	43 cm
Seat depth	25 - 37 cm	28 - 45 cm	31 - 48 cm
Lower leg length	up to 40 cm	up to 50 cm	up to 60 cm
Total back height	85 cm	90 cm	95 cm
Packing dimensions: WDH	60 x 90 x 59 cm	65 x 94 x 62 cm	70 x 104 x 66 cm
Payload/user weight	max. 50 kg	max. 70 kg	max. 85 kg
Additional load basket below seat	max. 4 kg	max. 4 kg	max. 4 kg
Additional payload Bag push handle	max. 3 kg	max. 3 kg	max. 3 kg
Frame weight folded (incl. cushion)	20 kg	22 kg	23 kg
Rear wheels, air	20"	20"	20"
Air pressure rear wheels	2,5 - 2,8 bar	2,5 - 2,8 bar	2,5 - 2,8 bar
Front wheels, air	see next table	see next table	see next table
Camber	5°	5°	5°
Seat angle	10°	10°	10°
Seat angle adjustment (optional)	approx. 0° - 30°	approx. 0° - 30°	approx. 0° - 30°
Back angle	120°	120°	120°
Backrest adjustment (optional)	approx. 110° - 140°	approx. 110° - 140°	approx. 110° - 140°

37.3 Additional information on length and front wheels

	Size S	Size M	Size L	Backrest -> front
12.5" rigid front wheel:				
Length in basic position: L	155 cm	168 cm	178 cm	
Air pressure	1,8 bar	1,8 bar	1,8 bar	
8" swivel wheel:				
Length in basic position: L	138 cm	151 cm	161 cm	
Air pressure	2,5 bar	2,5 bar	2,5 bar	
12.5" front wheel Pro:				
Length in basic position: L	156 cm	169 cm	179 cm	
Air pressure	1,8 bar	1,8 bar	1,8 bar	

38. Type-label and symbols

The weather-resistant type label of the JOSI-Wismi G2 E-Drive is located on the frame tube between the two rear axle plates.

△ If the type-label is no longer legible, be sure to contact your specialist dealer so that a new type-label can be requested from the manufacturer.

38.1 Symbols on the type-label

	European conformity
	Medical device
	Follow the instructions for use
	Follow the safety instructions in the instructions for use
	Maximum load (excluding maximum load for bag JW-35100: 3 kg and basket JW-35101: 4 kg)
	Article number of the product
	Serial number of the product
	Date of manufacture of the product
	Manufacturer of the product

39. Manual Decon E-Drive

△ See enclosed manual Decon E-Drive



John GmbH

Ziddelrasen 1b - D-99830 Treffurt - Tel: +49 36923 8388-0 - Fax: +49 36923 8388-10 - info@johnngmbh.com