

## TAWI Mobile Order Picker

# Time-efficient order picking



**TAWI**

# Efficient warehouse logistics with mobile order picking

Good ergonomics is an effective way of making your business more productive and profitable. This mobile vacuum lifter enables one person to do what has often been a two-man job.

 Ergonomic

 User friendly

**Swedish quality. Global solutions.**

**TAWI lifting equipment** has been facilitating ergonomic material handling for decades, and by customizing our solutions to your specific needs we can guarantee that they will help lift your business.

**TAWI Mobile order picker** offers a unique solution for order-picking from pallet racks, shelves or conveyors. Simply pick up the lifting unit with any kind of pallet jack or truck and drag or drive wherever you need to go.



**“We use TAWI lifting equipment every day, the lifters are easy to use, reliable and facilitates our daily work. The feeling of moving our products effortlessly is amazing”**

**Markus Widén**  
Production manager, Ferrita, Sweden



## Pick and lift just about anything, anywhere



The lifter easily handles a wide variety of loads including parcels, sacks, boards, drums and more.

Handout

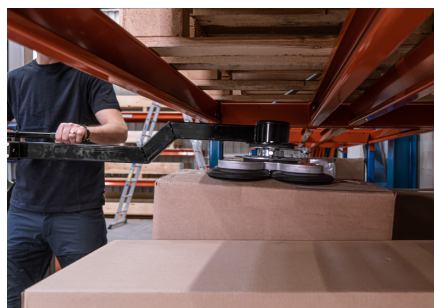

A vacuum lifter on an articulating arm enables you to reach far into pallet racks.

TAWI Mobile Order Picker

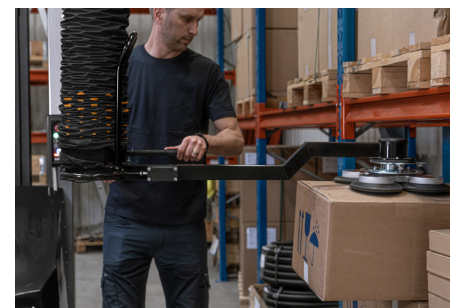

Lift up to 80 kg without physical effort. The lifter saves the operator from lifting in uncomfortable positions.



Achieve successful warehouse order fulfilment with our mobile order picker

## TAWI Mobile order picker - helps you double productivity

**The challenge** - while other operations in a warehouse can be automated, order picking largely remains manual. You will probably find that at least 50% of labour costs in your warehouse are related to order picking - a great potential for cost savings.

**The solution** - our mobile vacuum lifter enables one person to do what has often been a two-man job. Anyone can now lift heavy goods and place them on pallets in a safe and ergonomic way.

**“The investment in TAWI lifting equipment pays off quickly due to the obvious health benefits for the employees”**

**Danny Flass**  
Production site supervisor, Rockwool, Belgium

# Solutions for successful warehouse order fulfilment

Achieve time-efficient order picking without compromising quality or worker health and safety. The order picker enables you to move quickly from pallet rack to pallet rack, picking goods onto pallet with minimal physical effort.

 Ergonomic

**The mobile order picker** is a mobile vacuum lift unit compatible with any LLOP.

 User friendly

**Using our mobile order picker** with the Easy Reach tool allows the operator to easily reach into pallet racks, picking goods from the back end of a pallet without moving a muscle. This saves the operator from lifting in uncomfortable positions.

**The order picker** is easily adjusted in height to match the height of your pallet racks.

**With a wide** selection of suction feet, you can easily find the tool needed to lift your goods. Need to lift more than one type of load? Add a quick coupling and easily switch between tools for various types of loads.

## Key features

- **Mobile vacuum lifter**
- **Easily attached to any forklift**
- **Quick start-up**
- **Stand-alone unit**
- **Integrated pump/battery**
- **Multiple tools for** lifting anything from boxes and sacks to laminate boards
- **Lift up to 80 kg** without physical effort



Thanks to the weight distribution of the Easy Reach tool, the operator can stand comfortably in the aisle while lifting a box from the back end of a pallet in the rack.

The load can be rotated 360 degrees before it is placed on the pallet, facilitating efficient utilization of the pallet space.

Handout

TAWI Mobile Order Picker



Support legs are automatically activated when the pump is started

## Smart functions



Integrated light panel facilitates work in dark spaces.



Battery and vacuum pump are integrated in the unit, protected by a robust cover.

## Quick and easy to use

- 1 **Attach TAWI Mobile** order picker to any pallet jack or truck.
- 2 **Drive where you** need to go.
- 3 **Park the unit** and activate the pump with the push of a button. Support legs are automatically lowered.
- 4 **Start loading/unloading your** goods.



Handout

TAWI Mobile Order Picker

## Technical specifications

Model	MOP VM40	MOP VM50	MOP VM60	MOP VM80
Lifting capacity (kg/lbs)	40/88	50/110	60/132	80/176
Max length lift tube (mm)	1750	1750	1750	1700
Lift tube ø (mm)	120	140	160	180
Stroke vacuum lifter (mm)	1340	1320	1320	1290
Stroke tower (mm)	500	500	500	500
Noise level, idle (dB)	76	76	76	76
Noise level, operation (dB)	75	75	78	78
Max lifting height* (mm)	1940	1920	1900	1890
with lowered tower (mm)	1440	1420	1400	1390
Battery charging procedure	Plug in electrical outlet (100-240V. For 100V use 3-phase charger. For 230V use single-phase charger. Grounded, 50-60Hz). Recommended 8 hours continuous charge.			
Battery pack replacement	Prolonged operational time is achieved by switching the battery pack. This procedure takes approx. 10 minutes.			
External power source	The unit can be connected to a 24V external power source.			
Up and down motions of tower	52-58 mm/s			
Weight of unit	630 kg			

\*From bottom of suction head (excl. suction foot)

## Technical drawings

Drawings on the following pages provide an overview of TAWI Mobile Order Picker in various perspectives. The table on the top right hand page lists dimensions for the unit equipped with different vacuum lifter models. All measures are in millimetres.

This top view illustrates the full range of motion achieved with the articulating arm.

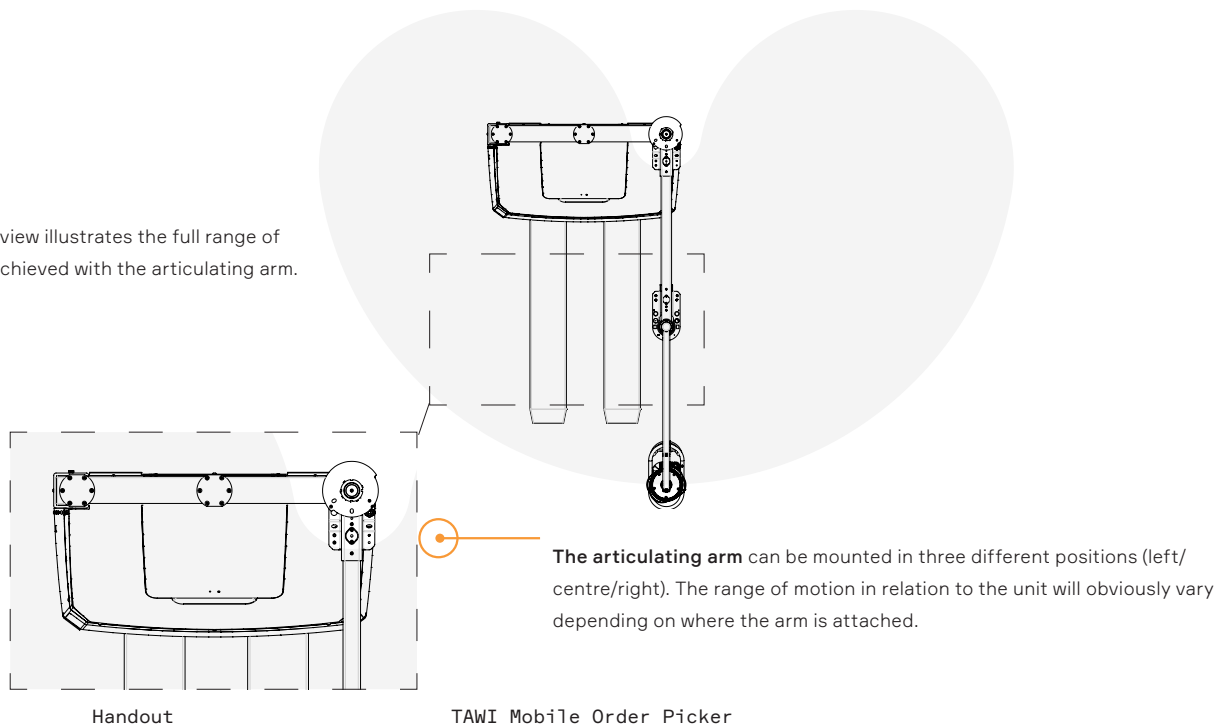

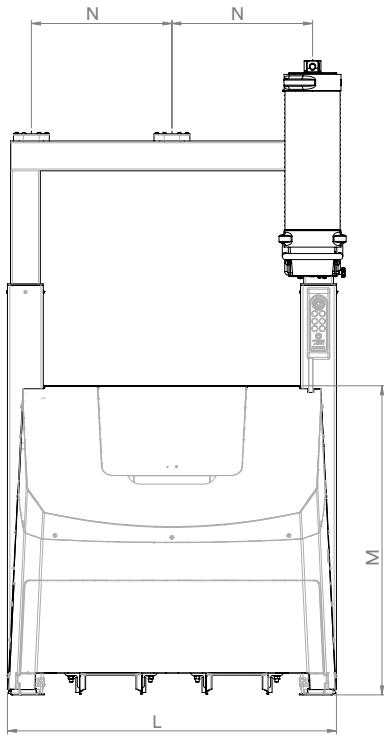

	MOP VM40	MOP VM50	MOP VM60	MOP VM80
A*	150	149	132	156
B	1340	1320	1320	1290
C*	1490	1469	1452	1446
D	592	613	630	637
E	2000	2000	2000	2000
F	1100	1100	1100	1100
G*	2000	2000	2000	2000
H*	2080	2080	2080	2080
I*	1850	1850	1850	1850
J	1150	1150	1150	1150
K	1710	1710	1710	1710
L	1100	1100	1100	1100
M	1130	1130	1130	1130
N	470	470	470	470

\*+500mm when tower is in elevated position.

The above drawing shows the lifting unit from the front, indicating the distance between attachment points for the lift arm (N).

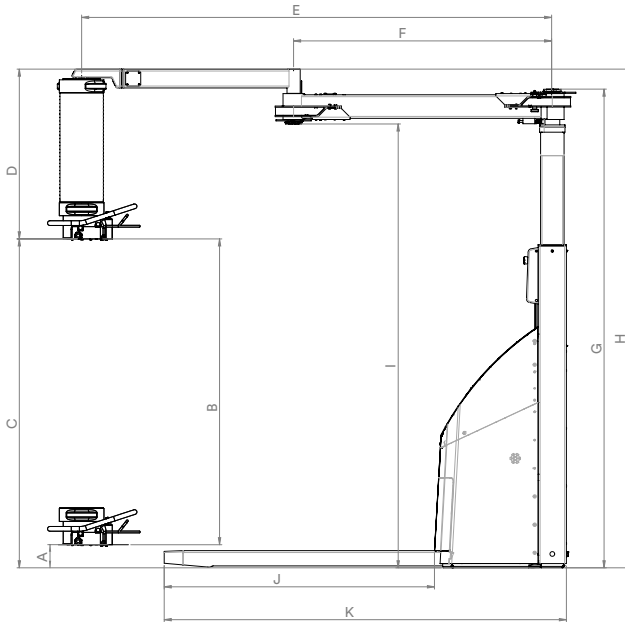

The left hand drawing shows the total height of the unit, the length of the articulating arm, the lifting height, and more.

Fork tunnels are adjustable to fit all types of fork lifts. See measures for both Euro- and US-forks in table and drawing below.

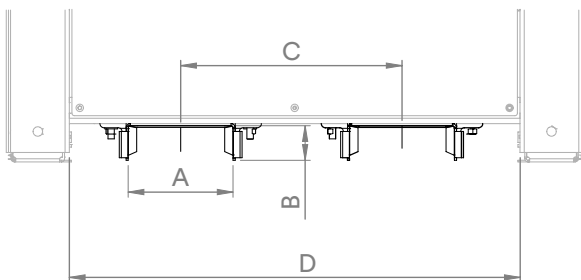

	Euro	US
A	200mm	332mm
B	65mm	66mm
C	315-535mm	365-495mm
D	860mm	860mm

Handout

TAWI Mobile Order Picker

# Smart lifting

## EUROPE

---

### Denmark

Risskov  
+45 8617 2266  
[eh.dk.mail@piab.com](mailto:eh.dk.mail@piab.com)

### France

Beauchamp  
+33 (0)139-95 65 00  
[eh.fr.info@piab.com](mailto:eh.fr.info@piab.com)

### Germany

Kaarst  
+49 (0)211-20 54 27 – 40  
[eh.de.info@piab.com](mailto:eh.de.info@piab.com)

### Netherlands

Helmond  
+31 492-52 37 05  
[eh.nl.info@piab.com](mailto:eh.nl.info@piab.com)

### Spain

Barcelona  
+34 933-20 59 84  
[eh.es.info@piab.com](mailto:eh.es.info@piab.com)

### Sweden

Täby (Piab Group HQ)  
+46 (0)8-630 25 00  
[info-sweden@piab.com](mailto:info-sweden@piab.com)

### Kungsbacka (TAWI HQ)

+46 (0)300-18 50 01  
[eh.info@piab.com](mailto:eh.info@piab.com)

### United Kingdom

Northampton  
+44 (0)1604-59 11 20  
[eh.uk.sales@piab.com](mailto:eh.uk.sales@piab.com)

### Italy

Volvera (TO)  
+39 (0)11 4143521  
[eh.it.info@piab.com](mailto:eh.it.info@piab.com)

## AMERICAS

---

### Brazil

Sao Paulo  
+55 (0)11-4492-9050  
[info-brasil@piab.com](mailto:info-brasil@piab.com)

### Canada

Richmond Hill (ON)  
+1 (0)905-881 16 33  
[eh.ca.info@piab.com](mailto:eh.ca.info@piab.com)

### USA

Bolingbrook (IL)  
+1 630-655 29 05  
[eh.us.info@piab.com](mailto:eh.us.info@piab.com)

## ASIA

---

### China

Shanghai  
+86 21 5237 6545  
[info-cn@piab.com](mailto:info-cn@piab.com)

### India

+91 8939151169  
[info-india@piab.com](mailto:info-india@piab.com)