

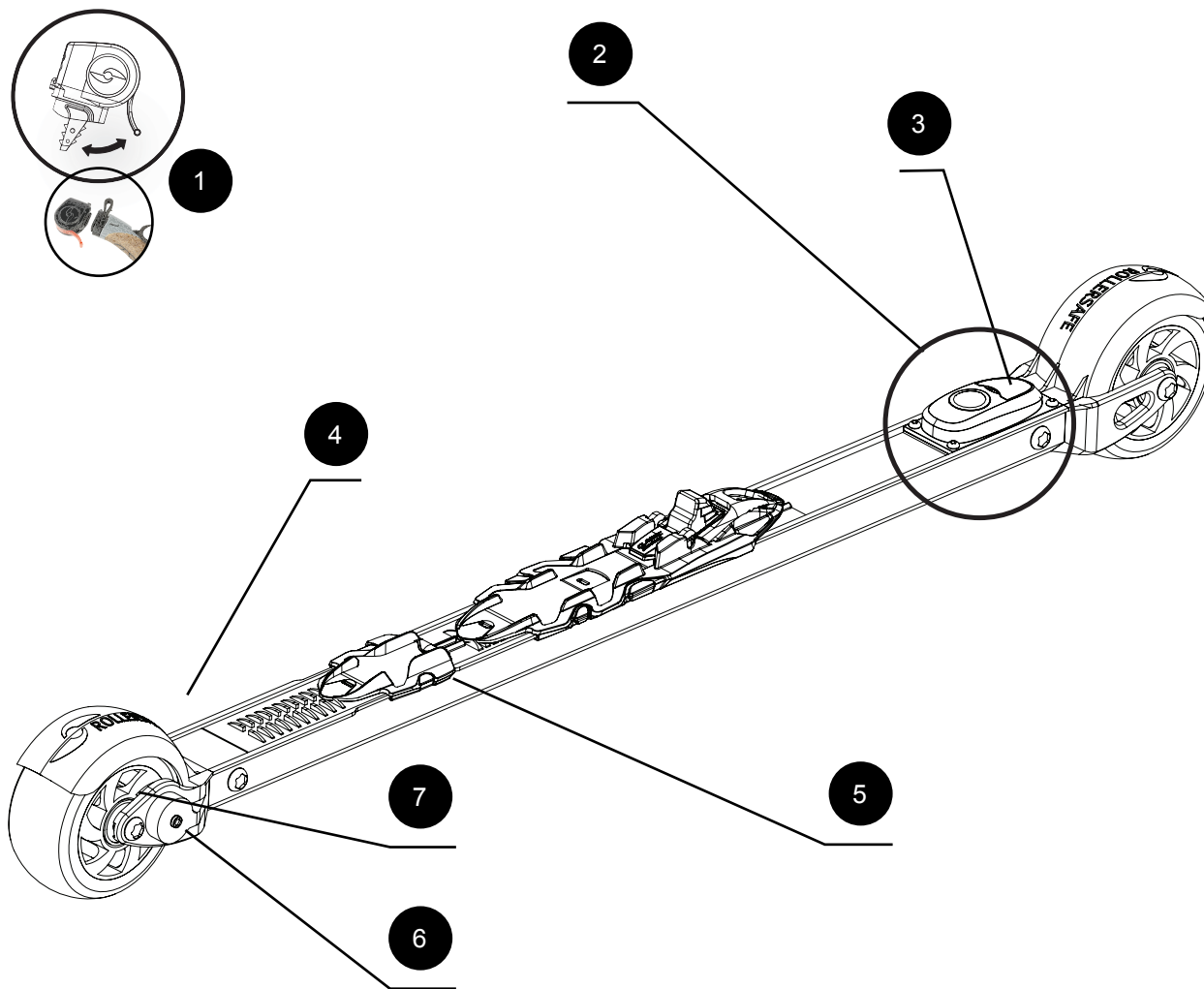

RS SKATE/RS CLASSIC

Get started / User Manual

THE ROLLERSAFE SYSTEM



- 1 Grip Controller Unit
- 2 Brake Controller Unit
- 3 Charging Latch (Rottefella tool provided)
- 4 Click-On Mud Guard
- 5 Slide-On Binding (Rottefella tool provided)
- 6 Brake Caliper
- 7 Brake Pads (Only use RollerSafe approved Brake pads)
- 8 Casing (Skate/Classic)
- 9 AC Adapter/ 2x USB cables
- 10 RollerSafe APP for Android/Apple Download: www.rollersafe.no

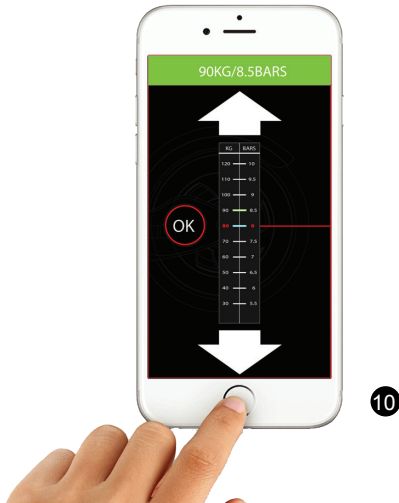
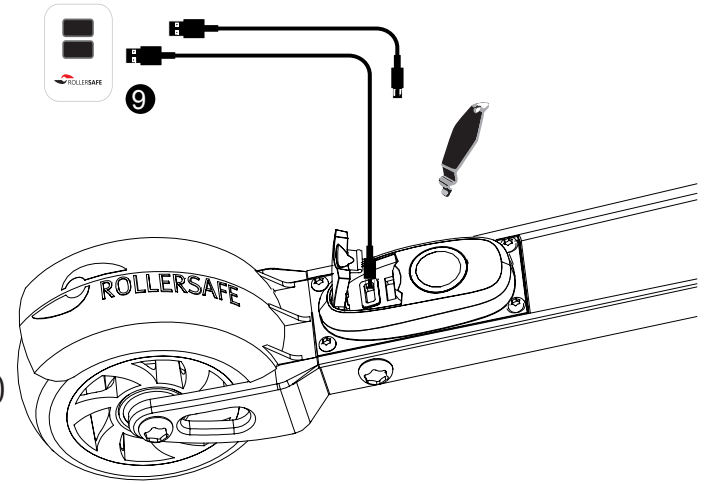

Must Read!

HOW TO USE YOUR ROLLERSAFE

1. Ensure that you set required brake force (mobile app); brakes should give soft speed reduction, WITHOUT BLOCKING the wheels
2. Always test the brakes on each ski BEFORE start and BEFORE you go downhill
3. Practise braking having controlled speed, outside traffic. Ensure you find good balance on your body when braking in different speed and situations (recommended to put one ski in front (see picture), and brake with this ski. Use the other brake as supplement if needed
4. Safe speed reduction implies good control of your balance at any time; to avoid dangerous situations, you should reduce speed early

AVOID AGRESSIVE BRAKING - BLOCKING WHEELS AND SUDDEN STOP CAN LEAD TO INJURIES!



HOW TO USE THE ROLLERSAFE APP?

1. Download the RollerSafe APP
2. Open the USB/Charging Latch with the Rottefella tool
3. Charge the ski with RS Adapter (9)
4. Log in to RollerSafe APP and find your skis under info page
5. Follow instructions:
 - adjust preferred brake force
 - see battery status
 - auto firmware update
 - user manuals video
 - webshop

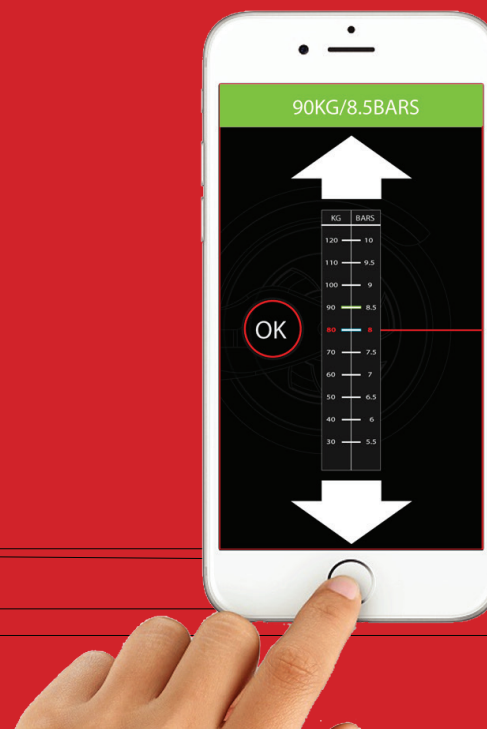
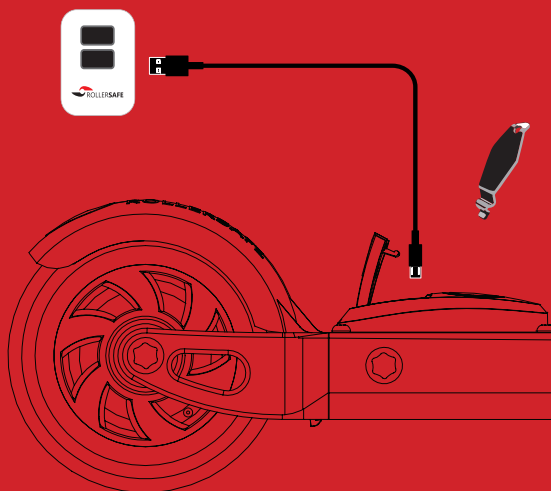

A. BATTERY CHARGING

Open Charging Latch (#3), insert USB Charging Cable (#9). Charging takes ~3 hours from 0-100%. LED in USB port blinks green during charging

B. BRAKE FORCE SETUP

Connect Mobile App (#10) when Charging Cable is inserted.
Adjust desired brake force according to weight/user profile

C. START UP SKIS

Push and hold for 2 sec start button on Brake Controller Unit (#2)
Wait 10 sec while brake automatically calibrates (LED light blinks RED)
LED light blinks GREEN every 5 sec, ready to use

D. SETUP GRIP CONTROLLER

Remove top plug from your ski pole
Insert RS Grip Controller plug (#1), ensure to fix it (taps on each side)
Slide on Grip Controller Unit, ensure to fix the tap (up)

E. SYNC SKI & GRIP CONTROLLER

For each ski: Hold Grip Controller close to Brake Controller. Push start button and trigger, hold for 5 sec. Ski and Grip Controller will immediately connect.
Repeat for the other Brake C./Grip C.

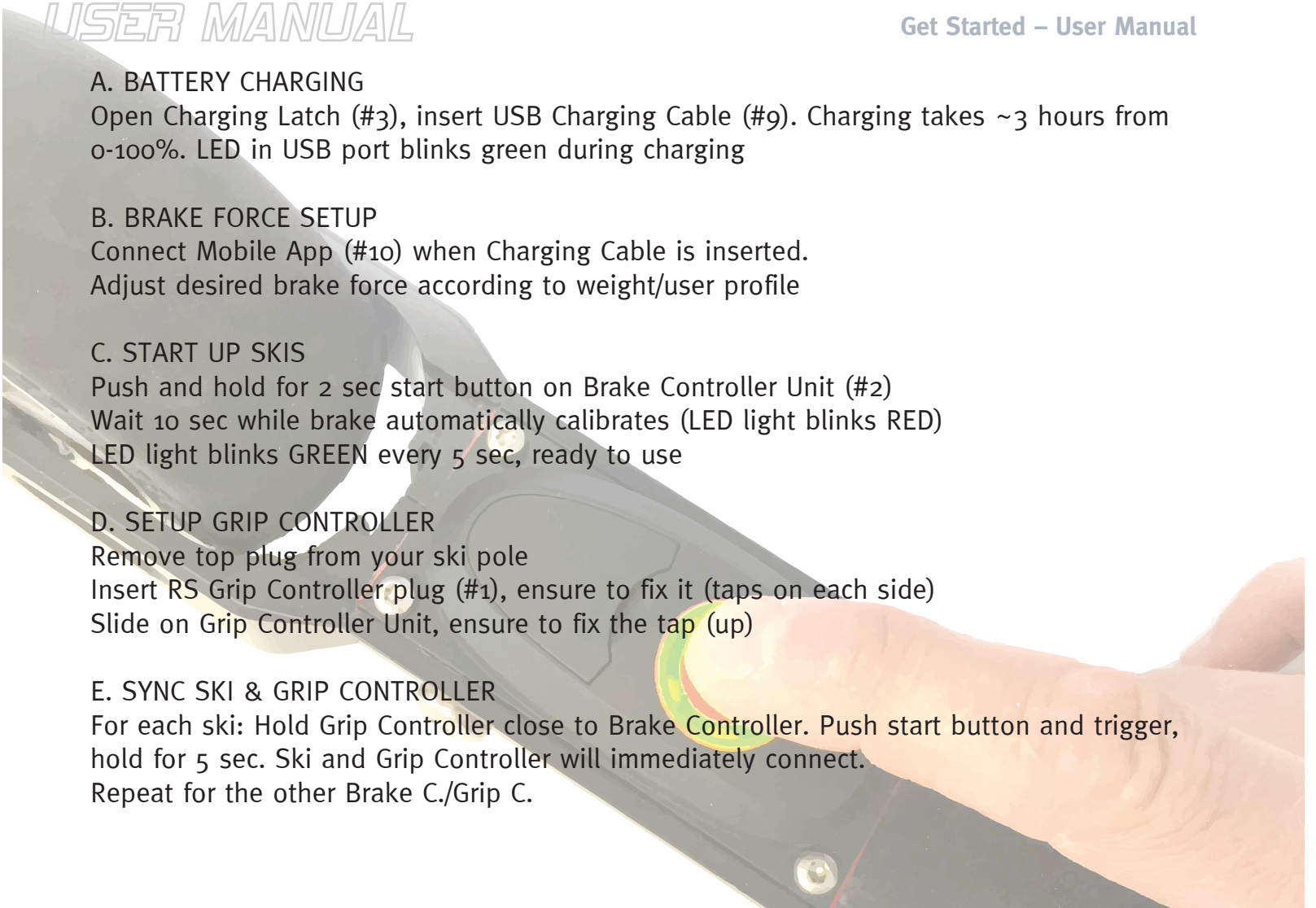

F. POWER OFF

Brake Controller automatically POWER OFF after 2 hours since last brake activity. Manual power off: Push and hold start button for 10 sec (LED stops blinking)

G. MAINTENANCE

Ensure cleaning your skis after use; remove water, gravel/dirt. Use a cloth and small brush

H. STORAGE

Safely store your RollerSafe skis and Grip Controllers in the RS Travel Case (#8)
Bring extra mud gards, wheels, spikes, Unbraco® and charging cable in the travel case

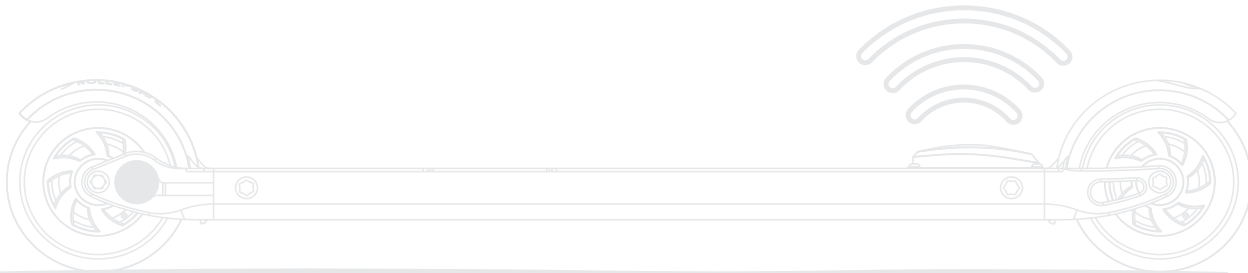

NOTE!

Some of the setup operations (battery charging, brake force setup and sync) will not be required for each trip, however, we strongly recommend to repeat these operations to ensure right setup for each user and for detection of any errors prior to use



www.rollersafe.no
post@rollersafe.no
+47 64 95 94 44
Slettaveien 18, 1555 Son
Norway