

Prevalon™ Seated Positioning System



Contents - Reorder # 7530/7531

1 Seated Positioning System Cushion, Fastener Strips, 1 Microclimate Management Pad

Contents - Reorder # 7535/7536

1 Seated Positioning System Cushion, Fastener Strips, 5 Microclimate Management Pads

Use:

Assists and maintains proper patient positioning and redistributes pressure associated with sitting in a bedside chair.

Caution:

- DO NOT use to lift patients.
- Only use with standard hospital chair, or rolling chair with brakes.
- Not recommended for use with a wheelchair.
- Patient positioning should always be performed following your facility's safe patient handling policies and procedures.
- Periodically check product for signs of wear. Replace if product is damaged.
- DO NOT launder. Wipe clean with a damp cloth.
- For single patient use only.
- Weight capacity: 350 lbs/160 kg

Instructions for Use:

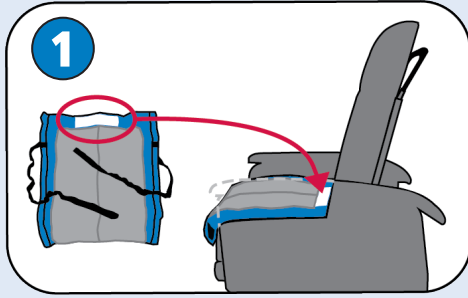

■ Prior to Positioning Patient:

Position chair with space behind for clinician(s) access. Lock chair brakes.

1. Place SPS on chair seat, with product tag at the back of the seat, facing up. Tuck slightly into chair crease. The clear air chambers should be in direct contact with the chair surface.

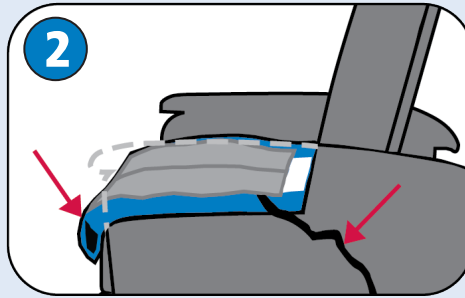

2. Make sure top layer of SPS is fully extended over the front of the seat. Keep handles accessible (not under patient).

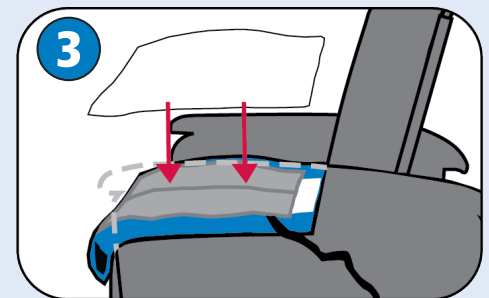

3. Cover SPS with the Microclimate Management Pad.



■ Positioning Patient

4. Following patient handling policy/procedures, assist patient onto chair and SPS.

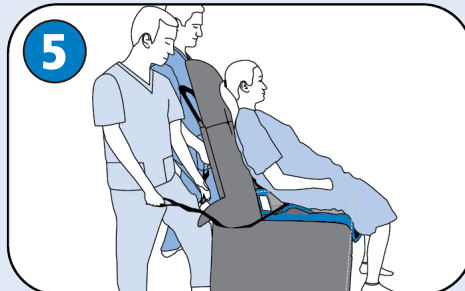

5. With patient safely seated, stand behind chair and grasp the nearest handle at a comfortable location. Brace a foot or leg on the back of the chair for support.



6. Simultaneously pull handles until the patient slides back into chair, in the upright seated position. Secure handles behind chair so they are safely out of the way.



■ Prior to Transferring Patient:

1. If desired, the SPS can be used to slide patient to the front of the chair.



2. From the front of the chair, grasp each handle at a comfortable position and pull them in an alternating manner (left, right, left, etc.).



3. Following patient handling policy/procedures, assist patient out of the chair.



Video instructions:

<http://sageproducts.com/videos/sps/training/>

Read instructions prior to use

SAGE®
PRODUCTS

Sage Products LLC

3909 Three Oaks Road • Cary, Illinois 60013

www.sageproducts.com

800-323-2220